



## Cavendish Road, NW6

£392 Per week

A spacious one bedroom apartment with a separate kitchen, reception room, bathroom suite, double bedroom and access to a communal garden. Perfect for a professional couple or single occupant.

Cavendish Road is near to numerous shops, cafes and restaurants of Queens Park's Salusbury Road. Excellent transport links include both Brondesbury Park and Brondesbury Overground stations and Kilburn underground.

### Features

- Victorian Property
- One Double Bedroom
- Large Living Room
- High Ceilings
- Separate Kitchen
- Communal Garden

# Cavendish Road, London, NW6

## Ground Floor

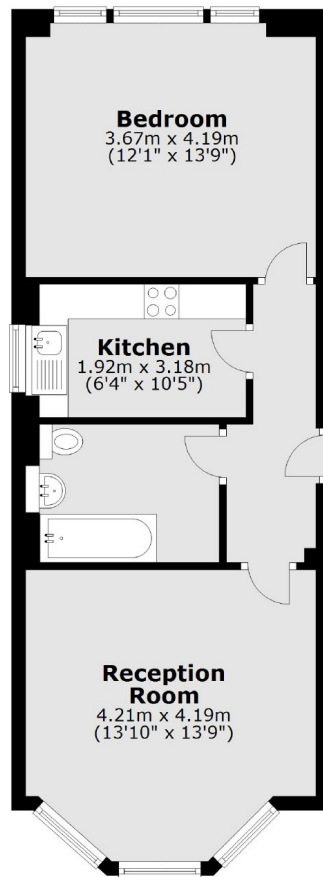

Total area: approx. 49.0 sq. metres (527.5 sq. feet)