



## Abbots Manor, SW1V

### £520,000

A spacious, three bedroom apartment located in this well maintained and popular purpose built development.

Abbots Manor is located in fashionable Pimlico where there are a variety of shops, cafes and restaurants. Transport links are good with Victoria Station, Pimlico and Sloane Square Underground nearby.

### Features

- No Onward Chain
- Private Balcony
- Three Bedrooms
- Leasehold
- Second Floor
- Purpose Built Block

# Abbots Manor, London, SW1V

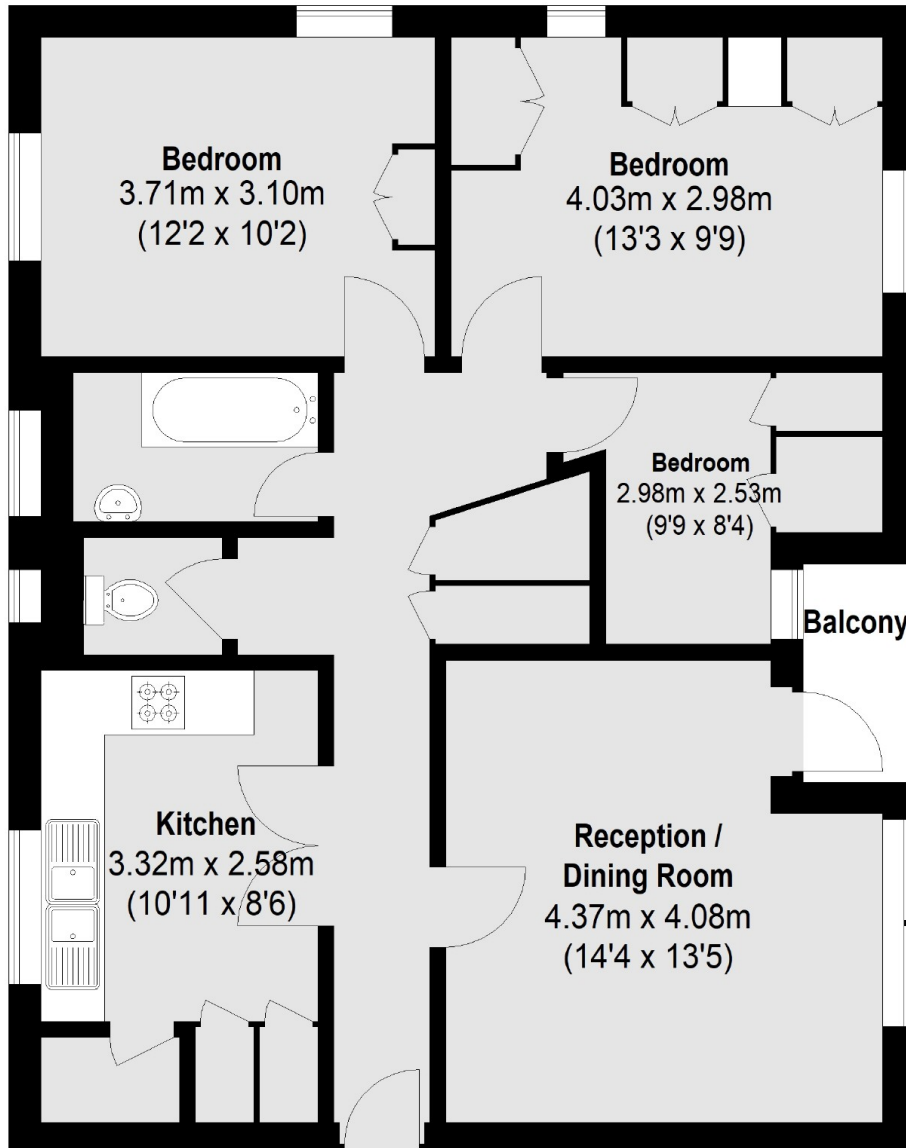

## Second Floor

Total area (approx.): 78.13 sq. m (841 Sq. ft)  
Balcony: 2.15 sq. m (23 Sq. ft)

# Dexters

Westminster  
50 Churton Street  
London  
SW1V 2LP  
Sales  
020 7590 9570

Energy Rating: C. We aim to make our particulars both accurate and reliable. However they are not guaranteed; nor do they form part of an offer or contract. If you require clarification on any points then please contact us, especially if you're traveling some distance to view. Please note that appliances and heating systems have not been tested and therefore no warranties can be given as to their good working order.

 **RICS** | Regulated  
Estate Agent  
and Letting Agent

[dexters.co.uk](https://www.dexters.co.uk)