



Leman Street, E1

£450,000

A one-bedroom, one bathroom property located in a secluded development on the edge of the City of London. This property offers a spacious, semi-open plan reception/kitchen with floor-to-ceiling doors leading onto the private balcony overlooking a well-maintained evergreen communal garden. The double bedroom provides built-in storage, with ample additional storage in the hallway. The development has its own concierge and 24/7 security.

This central location provides great transport links throughout London and is a short walk from The City. The property is in close proximity to Algate East (Hammersmith & City, District), Aldgate (Circle, Metropolitan), Liverpool Street (Underground, Overground and Mainline) and Shadwell (Windrush, DLR). The local area offers fantastic amenities including several bars, cafes, restaurants, gyms and a luxury cinema."

Features

- One Double Bedroom
- Private Balcony
- Separate Kitchen
- Built In Storage
- Great Transport Links
- Modern Design

Leman Street,
London, E1

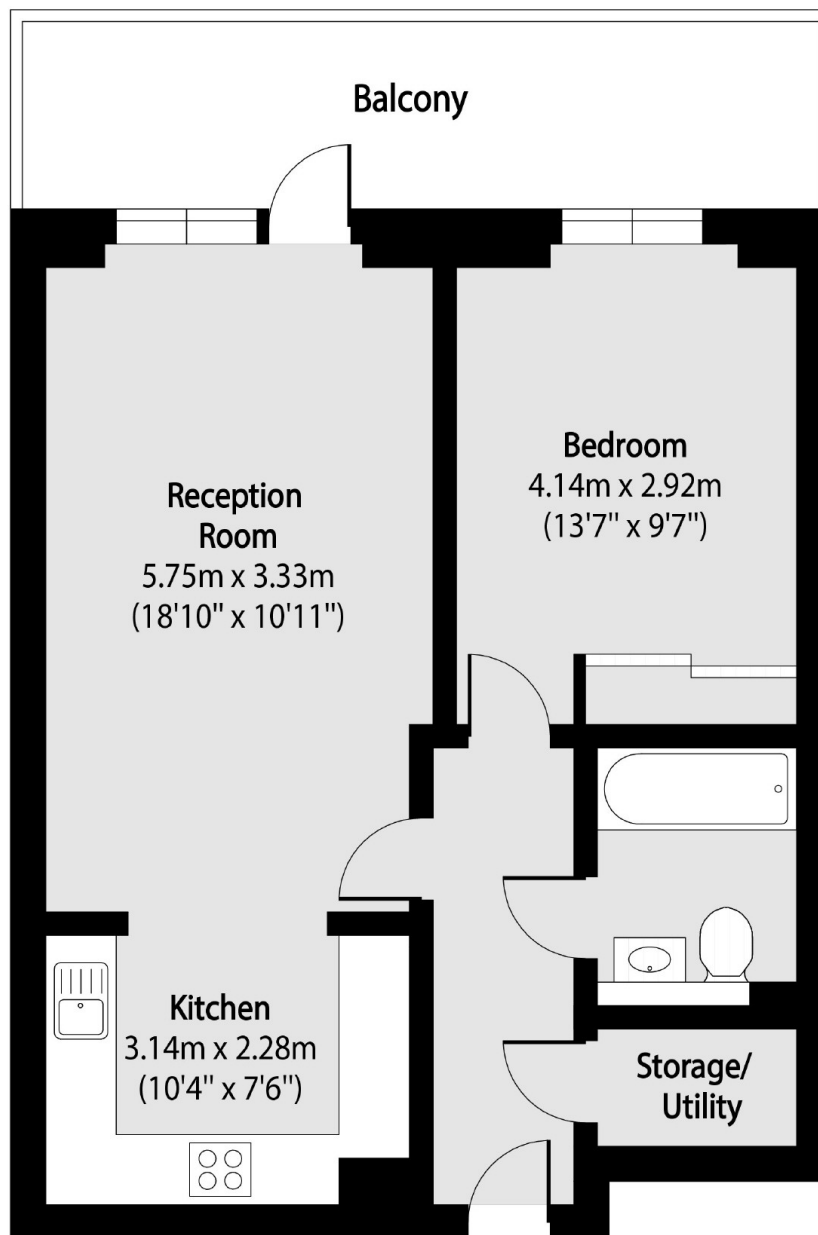

Total area (approx): 51.33 sq m (553 sq. ft)

Balcony total area (approx): 10.88 sq m (117 sq. ft)

Dexters

Shoreditch
44 Great Eastern Street
London
EC2A 3EP
Sales
0207 483 6371

Energy Rating: C. We aim to make our particulars both accurate and reliable. However they are not guaranteed; nor do they form part of an offer or contract. If you require clarification on any points then please contact us, especially if you're traveling some distance to view. Please note that appliances and heating systems have not been tested and therefore no warranties can be given as to their good working order.

 **RICS** | Regulated
Estate Agent
and Letting Agent

[dexters.co.uk](https://www.dexters.co.uk)