



Diss Street, E2

£350,000

This one bedroom apartment is located on the third floor of this Grade II-listed block, walking distance to Hoxton Overground station. This property provides a separate kitchen and reception area with large windows for plenty of natural light, a good sized bedroom and a family bathroom. The flat has modern touches throughout and is within 200 yards of Columbia Road.

Located within a quarter of a mile from Hoxton Overground station and Columbia Road, the property has excellent connections into the City with restaurants and bars all close by.

Features

- Double Bedroom
- Modern Bathroom
- Secure Entry
- Lift Access
- Furnished
- Close to Columbia Road

Diss Street,
London, E2

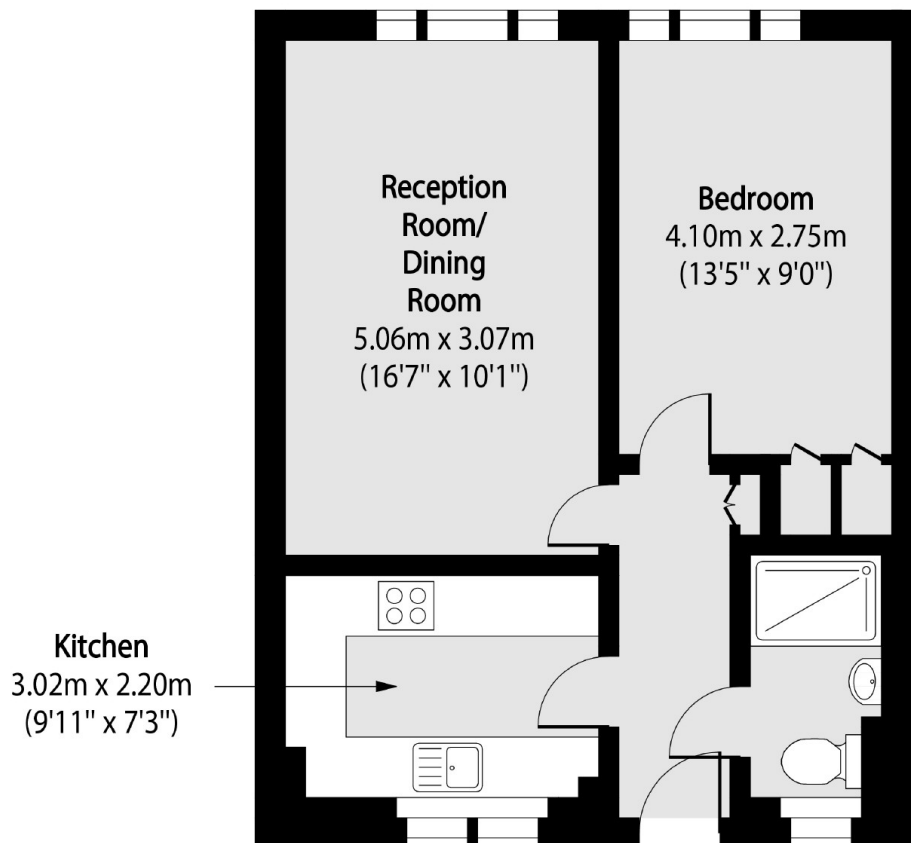

Total area (approx): 44.70 sq m (481 sq. ft)

Dexters

Shoreditch
44 Great Eastern Street
London
EC2A 3EP
Sales
0207 483 6371

Energy Rating: C. We aim to make our particulars both accurate and reliable. However they are not guaranteed; nor do they form part of an offer or contract. If you require clarification on any points then please contact us, especially if you're traveling some distance to view. Please note that appliances and heating systems have not been tested and therefore no warranties can be given as to their good working order.

RICS | Regulated
Estate Agent
and Letting Agent

[dexters.co.uk](https://www.dexters.co.uk)