



## Long Street, E2

### £600,000

An bright, 2 bedroom apartment with generous living space. The property benefits from a contemporary built-in kitchen with a Bosh washer/dryer and Miele Appliances along with conditioning throughout. Residents have access to a 24 hour concierge, private library, resident gym, spa and cinema room which is bookable upon request as well as a multi levelled landscaped garden and sun deck.

Within walking distance of major transport hubs such as Liverpool Street station. Home to Cross rail with direct lines to Heathrow Airport, Central Line, Hammersmith and City and national rail services.

### Features

- Air Conditioning
- Gated Community
- Residents Facilities
- Two Double Bedrooms
- Close to Transport Link
- Bicycle Storage

# Long Street, London, E2

## First Floor

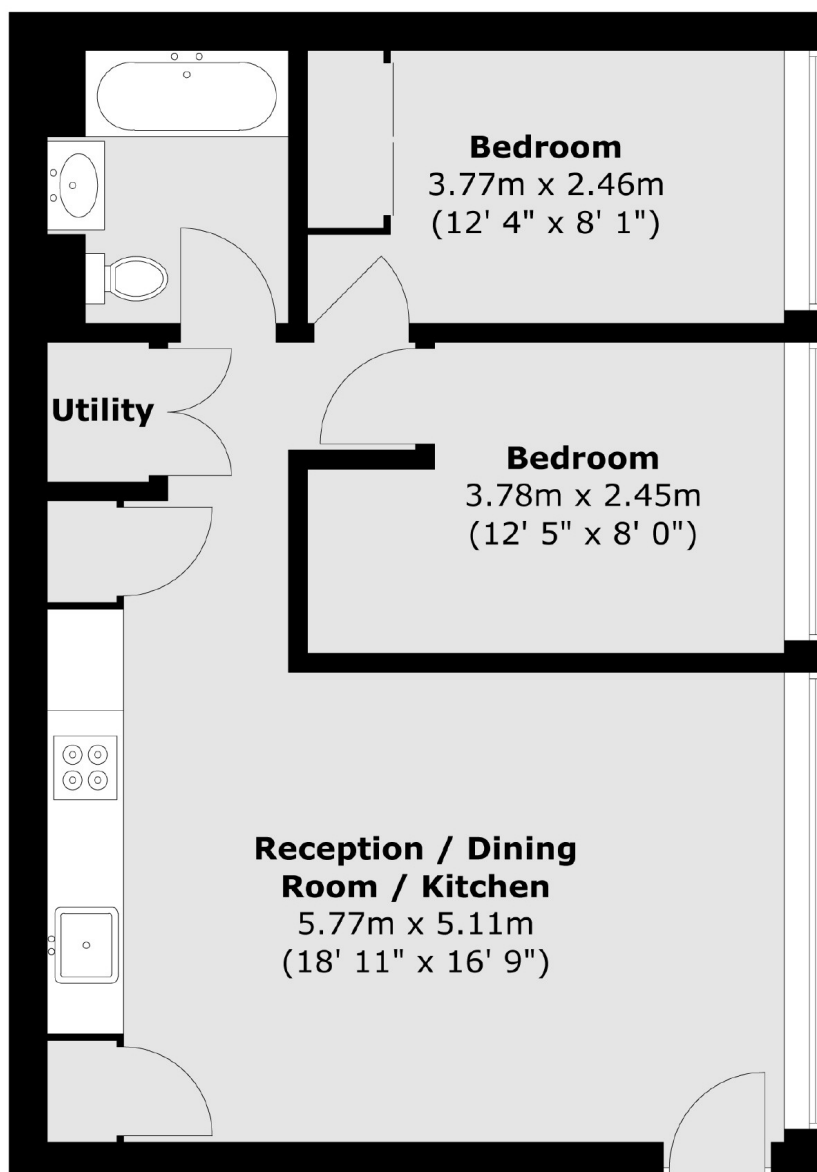

Total area (approx.) : 50 sq. m (538 sq. ft)