



Woodseer Street, E1

£700,000

Two bedroom apartment in sought after conversion set just off of Brick Lane. The apartment has a large, open plan living room with space to dine and two bedrooms with ample built in storage. The hallway has further storage for the resident and also has the family bathroom. The apartment is full of natural light and the apartment comes with the benefit of a share in the freehold

Woodseer Street, just off Brick Lane, the flat offers a peaceful setting amidst Shoreditch's vibrant lifestyle. You're only moments from an eclectic mix of cafés, vintage shops, markets, and galleries. Shoreditch High Street Overground and Liverpool Street Station are both within easy reach, offering excellent connectivity across London. The green space, Weavers Fields Gardens, is also close by.

Features

- Two bedrooms
- One bathroom
- Share of freehold
- Warehouse inspired
- Sought after location
- City views

Woodseer Street, London, E1

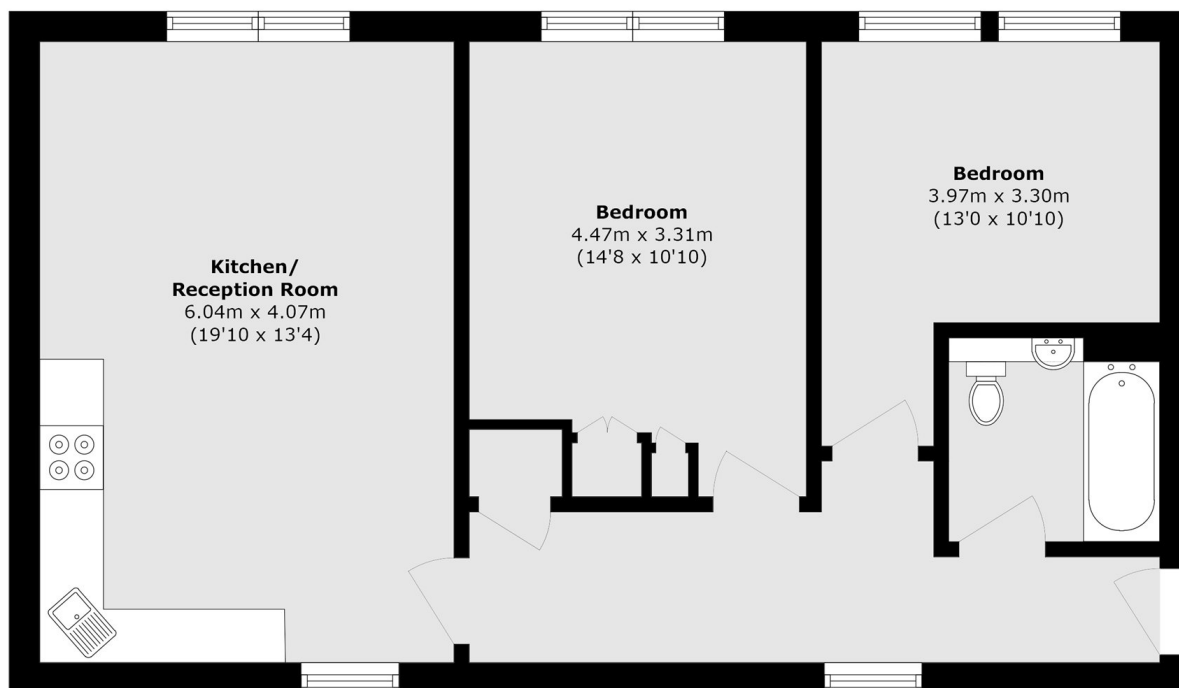

Total area (approx.): 67.1 sq. m (722.2 sq. ft)