



## Soho Square, W1D

£725 Per week

**Dexters**





## Soho Square, W1D

A rarely available and architecturally designed one bedroom top floor apartment within this prominent Grade II listed house on one of the West Ends rare and most sought after garden squares.

Situated on one of the few green open spaces in the Soho Conservation area, prominently stands No 15 Soho Square. This Grade II listed house is one of only two surviving original houses to the square and dates back to circa 1677.

Previously home to an eclectic mix of inhabitants including Lords, Earls and Countesses the house has now been painstakingly converted into four unique and luxurious apartments, consisting of two, one bedroom units, a two bedroom and a two/three bedroom duplex.

The house overlooks the square and is perfectly positioned for easy access to all the amenities the West End has to offer. It is well served for a wide array of transport links and is within 1km radius of Oxford Street, Covent Garden & Piccadilly Circus.

### Features

- Grade II Listed
- Overlooking Square
- Central Position
- Exposed Beams
- Stripped Floors
- Loft Style



# Soho Square, London, W1D

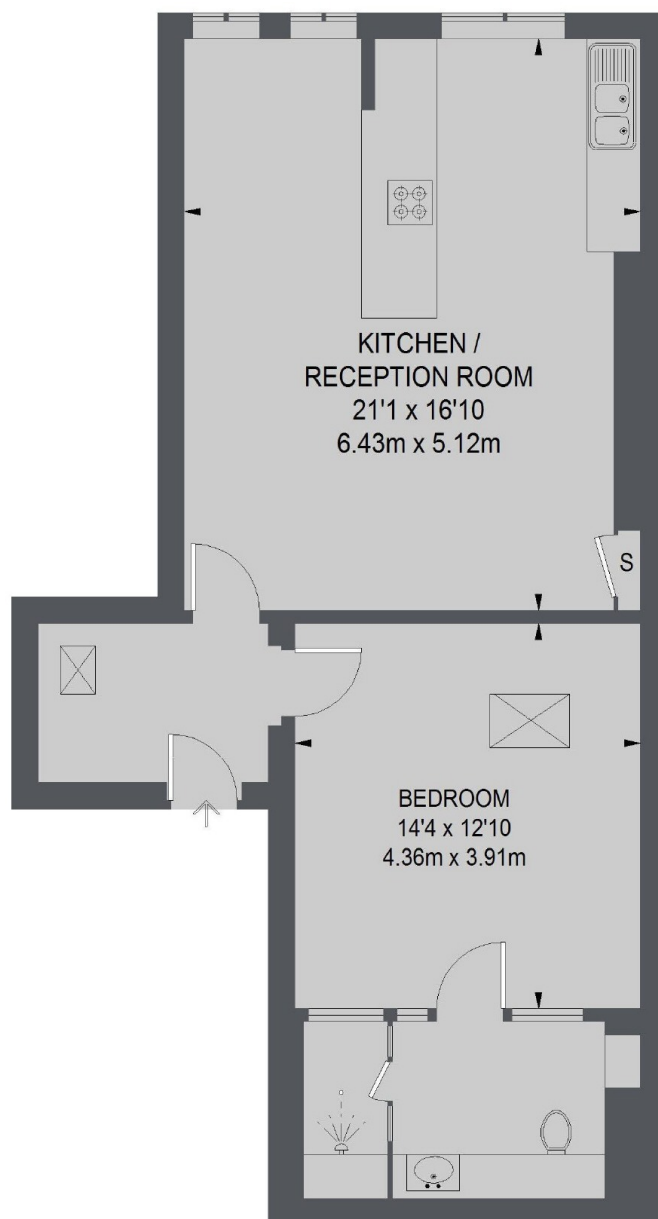

THIRD FLOOR

TOTAL APPROX. FLOOR AREA 696 SQ. FT. (64.73 SQ. M.)