



Newman Street, W1T

£550 Per week

This sophisticated apartment is located in the heart of Fitzrovia. It features a large terrace, including a reception room with dining space, along with fully-equipped kitchen and a double bedroom with ample storage. The building offers secure entry and lift access for added peace of mind, and a generously sized private terrace.

Newman Street runs north of Oxford Street and up to Goodge Street, making it an ideal location for those who want to be right in the heart of it West End.

Features

- Newly Refurbished
- First Floor
- Lift Access
- Private Terrace
- Fully Furnished
- Central Location

Newman Street, London, W1T

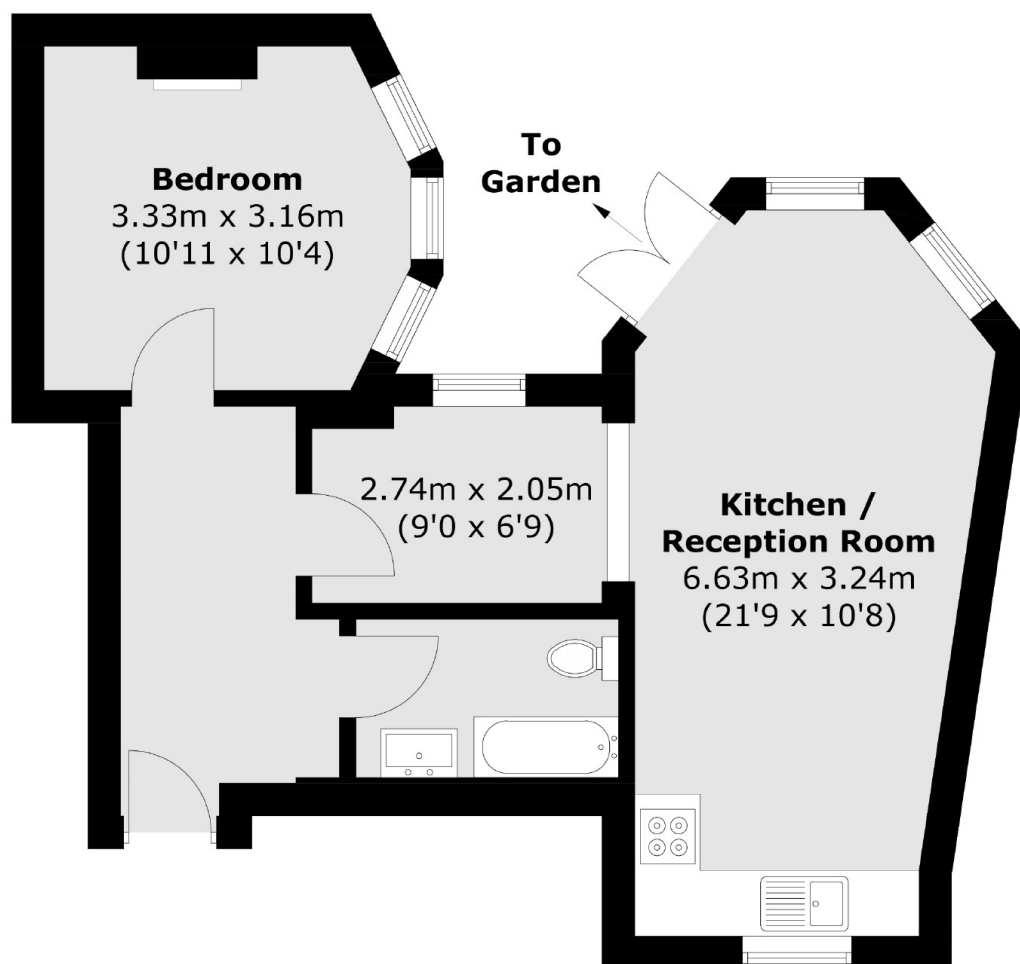

Total area (approx.): 45.4 sq. m (488.7 sq. ft)