



## Ilbert Street, W10

### £425,000

A generously sized three-bedroom flat set on the first floor of a purpose-built block, offering fantastic potential for renovation and personalisation. The property features a spacious separate reception room with access to a private balcony, a large kitchen, and is ideally located in a highly sought-after area.

Queens Park Court is located in a quiet residential area near the ever-popular Queens Park Conservation Area, with access to the shops, cafes, restaurants and bars on Chamberlayne Road. Transport links include Kensal Rise (Overground) and Kensal Green (Bakerloo & Overground).

### Features

- Three Bedrooms
- First Floor Flat
- Balcony
- In Need of Modernisation
- Great Location
- Chain Free

# Ilbert Street, London, W10

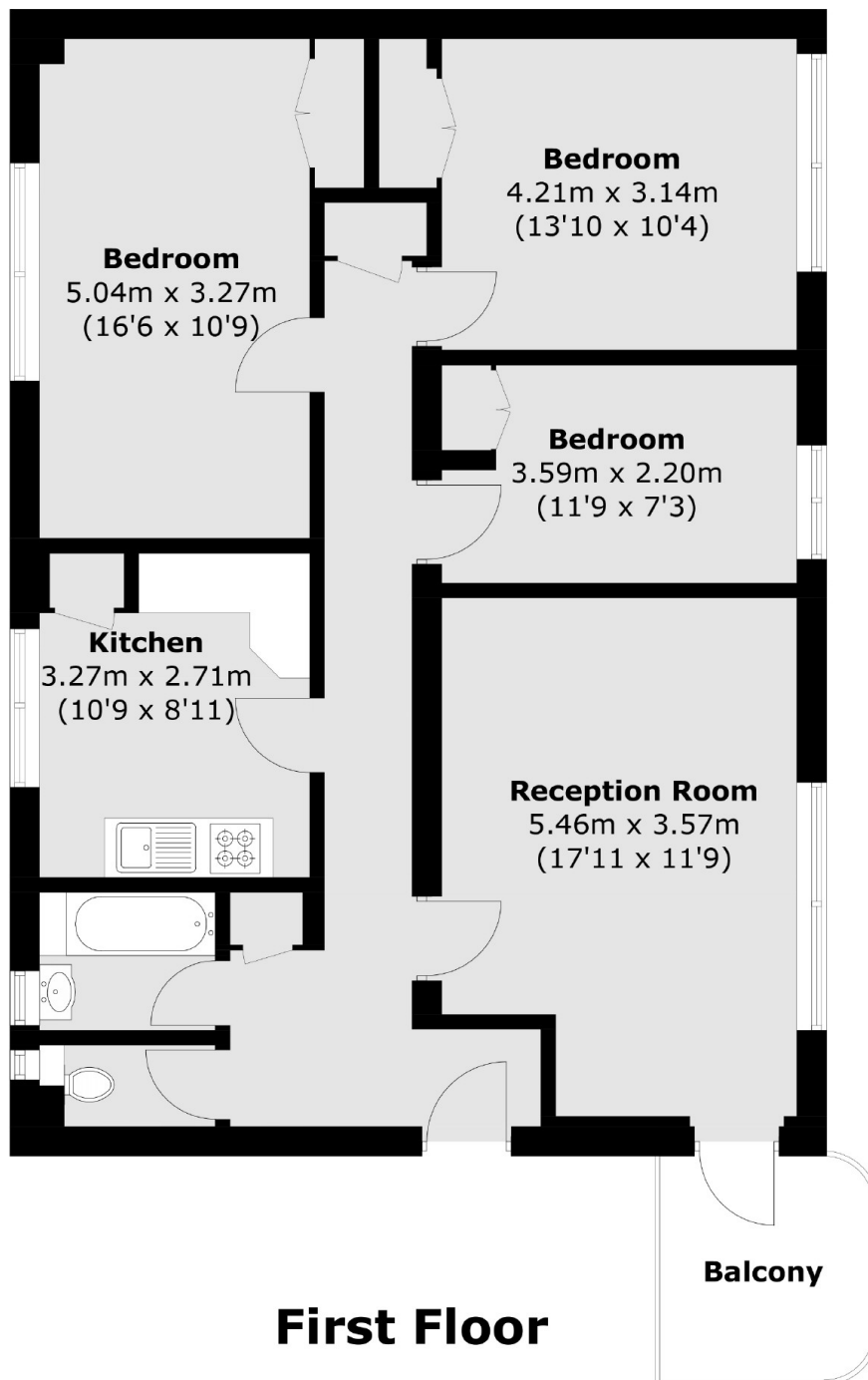

Total area (approx.): 84.1 sq. m (905.2 sq. ft)  
Balcony : 4.7 sq. m (50.5 sq. ft)