



## Kilburn Lane, W10

### £400,000

A spacious two bedroom flat in a modern purpose-built gated development, located between Kensal Rise and Maida Vale. The property has a south facing reception room and is flooded with natural light throughout, has a separate fully integrated kitchen, built-in storage, and has allocated gated parking.

Kilburn Lane is in close proximity to local shops, cafes, restaurants and bars on Chamberlayne Road, and Salusbury Road in Queen's Park, along with the green open spaces. Transport links include Queen's Park (Bakerloo & Overground), Kensal Rise (Overground) and Kensal Green (Bakerloo & Overground).

### Features

- Two Bedrooms
- South Facing Reception Room
- Lift
- Allocated Parking Space
- Communal Courtyard
- Chain-Free

**Kilburn Lane,  
London, W10**

## Second Floor

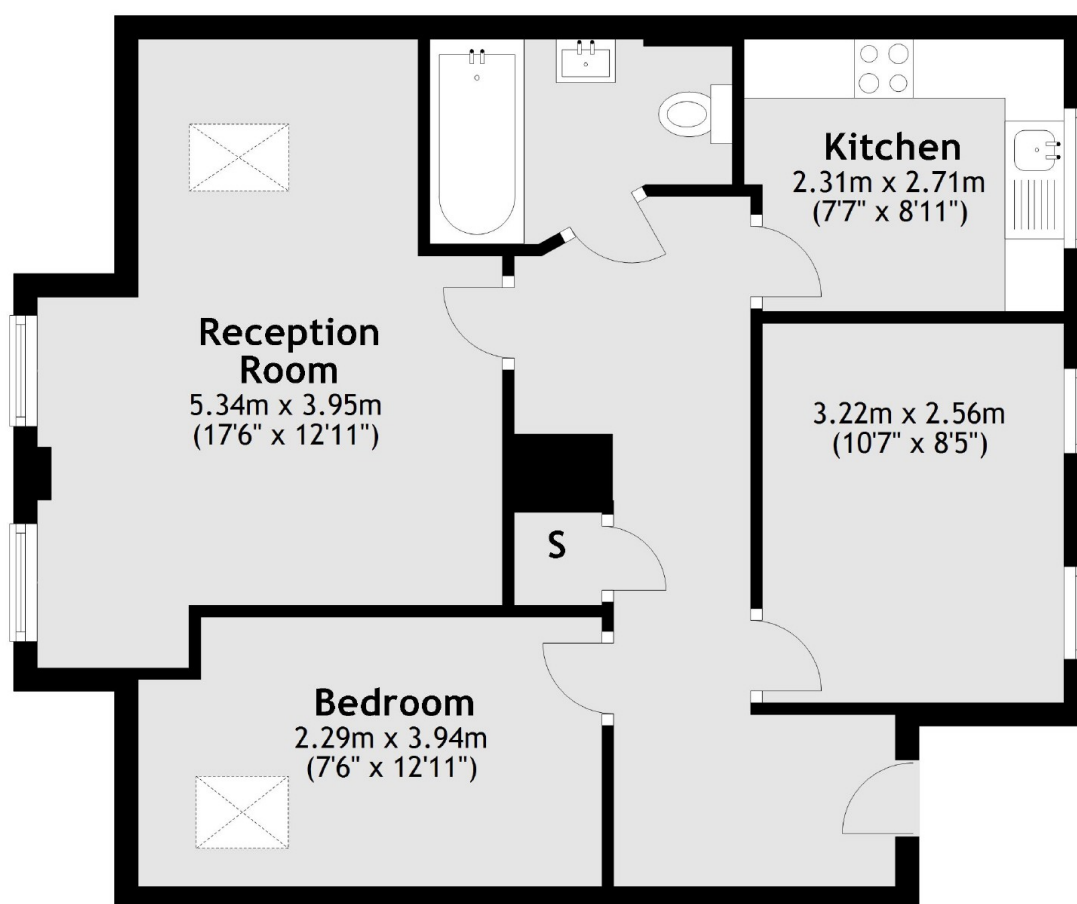

Total area: approx. 57.0 sq. metres (613.9 sq. feet)