



JUNIPER DRIVE, SW18

£550,000

- Two double bedrooms
- Two bathrooms
- Allocated parking
- High specification
- Private balcony
- Energy rating: B





ABOUT THE HOME

A high specification, two double bedroom, modern apartment in the ever popular Battersea Reach development.

Accommodation comprises; an airy and bright open plan kitchen/living room providing access onto a private balcony, two good sized double bedrooms and two modern bathrooms. The property benefits from a useful storage cupboard in the entrance hall as well as air conditioning throughout and private underground parking. Residents benefit from 24-hour concierge & an exclusive gym, as well as on-site amenities like Tesco Express, Young's Bar & Restaurant, Edible Foods Café, yue float wellness centre & beauty salon.

Battersea Reach is a desirable riverside development which is ideally positioned for easy access to Central London via Wandsworth Town Station and Clapham Junction. Whilst being a short distance from the popular shops, bars and restaurants of Wandsworth Town and Northcote Road, it is also just across the bridge from Fulham. The Riverbus stop at St Mary's Wandsworth [Pier](#) offers a fast and convenient commute into the City and out to Canary Wharf.





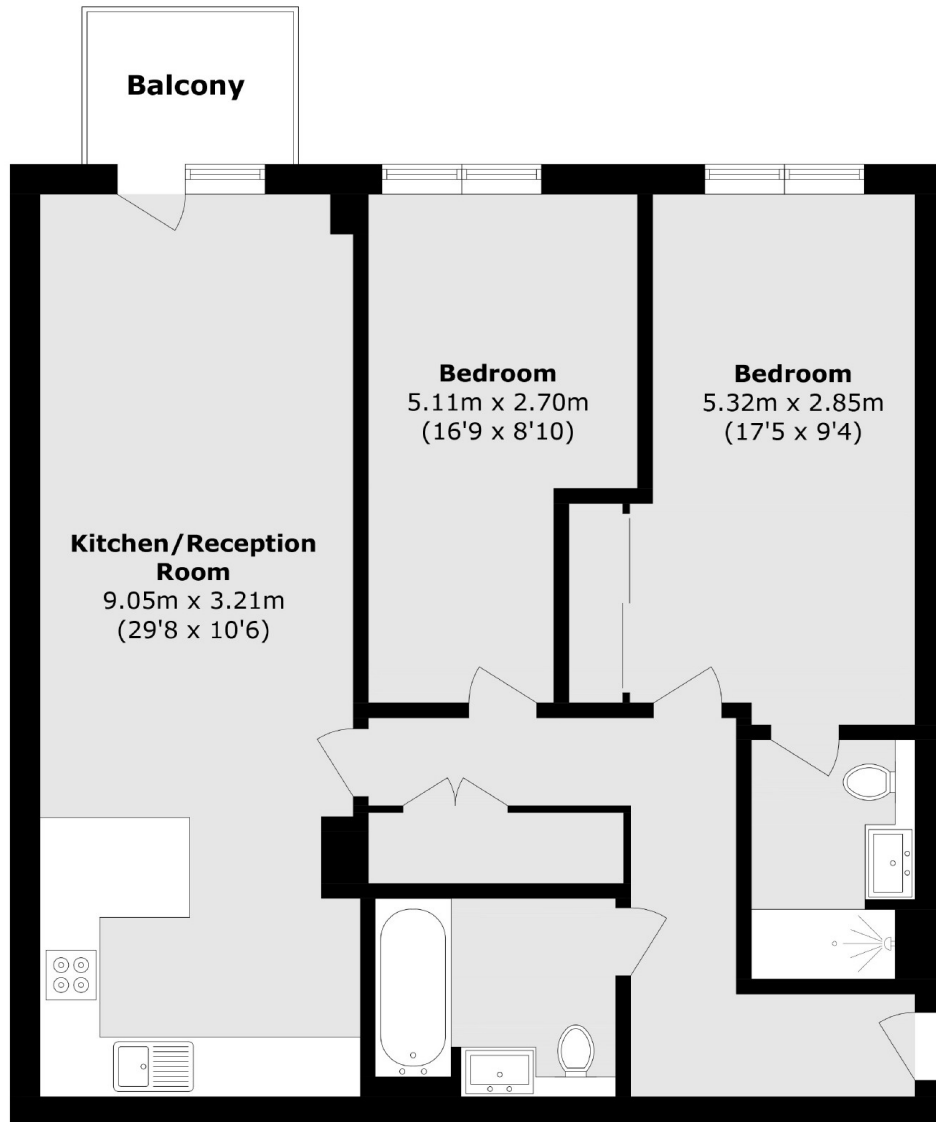

Total area (approx.): 79.3 sq. m (835.5 sq. ft)
Balcony area (approx.): 3.1 sq. m (33.3 sq. ft)

JACKSONS EARLSFIELD

372-374 Garratt Lane,
Earlsfield, London, SW18 4ES
Sales: 020 8971 7979
Lettings: 020 8971 7070

Energy Rating: B We aim to make our particulars both accurate and reliable. However they are not guaranteed; nor do they form part of an offer or contract. If you require clarification on any points then please contact us, especially if you're traveling some distance to view. Please note that appliances and heating systems have not been tested and therefore no warranties can be given as to their good working order.