



SHIRE PLACE, SW18

£650,000

- Freehold house
- Two double bedrooms
- Large private garden
- Excellent condition
- Private allocated parking
- Energy rating: C





ABOUT THE HOME

A charming, two bedroom, modern built mid terrace house which has been tastefully decorated throughout and offers exceptional entertaining space.

The ground floor comprises of an entrance hall, useful under stair storage cupboard, modern kitchen to the front, an impressive reception room to the rear which is open plan to the dining area and boasts sliding glass doors onto a beautifully maintained, large private garden with a storage shed. Upstairs there are two excellent double bedrooms; the principle bedroom benefitting from built in wardrobes and a well presented family bathroom. The property further benefits from private off-street parking and a visitors pass.

Shire Place is a gated development located just off Swaffield Road. This location is highly sought after, being equidistant from Earlsfield and Wandsworth Town and is very well served by excellent transport links, trendy coffee shops, restaurants, bars, leisure and shopping facilities all within close proximity of the property.





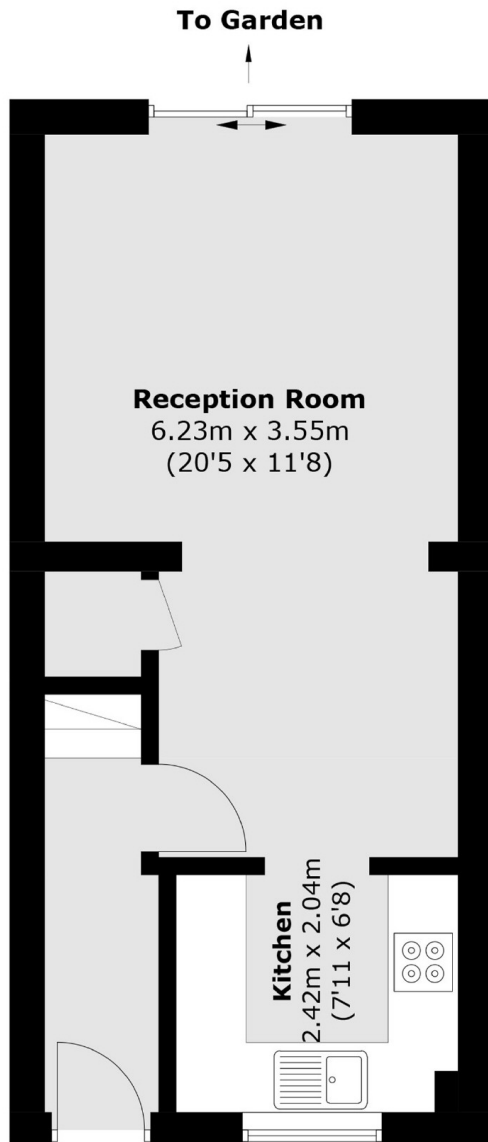

Ground Floor

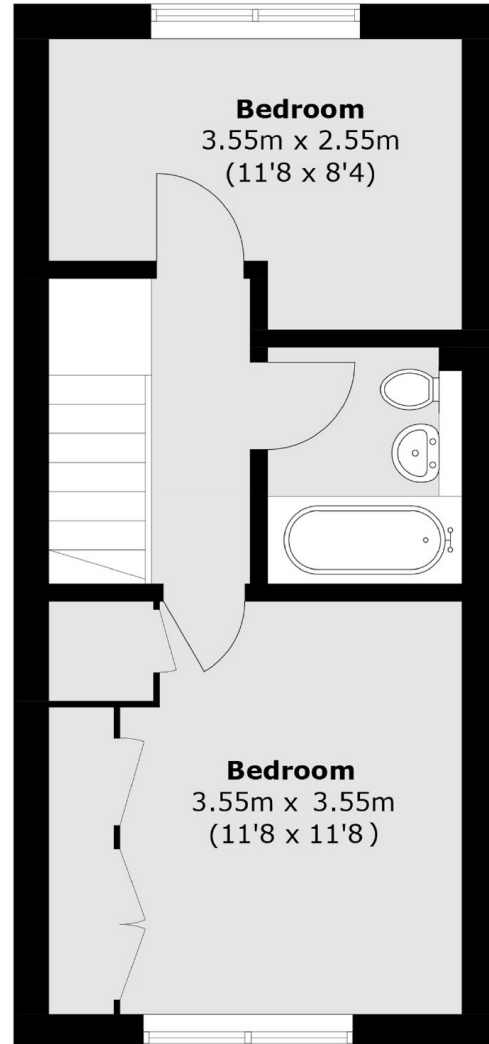

First Floor

Total area (approx.): 59.9 sq. m (644.8 sq. ft)

JACKSONS EARLSFIELD

372-374 Garratt Lane,
Earlsfield, London, SW18 4ES
Sales: 020 8971 7979
Lettings: 020 8971 7070

Energy Rating: C We aim to make our particulars both accurate and reliable. However they are not guaranteed; nor do they form part of an offer or contract. If you require clarification on any points then please contact us, especially if you're traveling some distance to view. Please note that appliances and heating systems have not been tested and therefore no warranties can be given as to their good working order.