



Barrow Road, SW16

£1,900 PCM

A large two bedroom flat within a 1930s art deco apartment block, located on a desirable road close to Streatham and Streatham common stations.

- Two Double Bedrooms
- Adjacent to Streatham Common
- Art Deco 1930s Mansion Block
- Close to Transport

For further information on the costs associated with renting a property, please pop into our office or visit our website.



Barrow Road is a quiet residential neighbourhood in between Streatham and Streatham Common train stations. Local amenities in Streatham are in abundance and include both independent and high street retailers, fitness and leisure facilities. There are also numerous cafés, restaurants, bars and pubs. Streatham Common Station offers transport into both Victoria and London Bridge whilst Streatham Station provides links into Blackfriars and Farringdon with a Thames Link Service as well as trains into London Bridge.



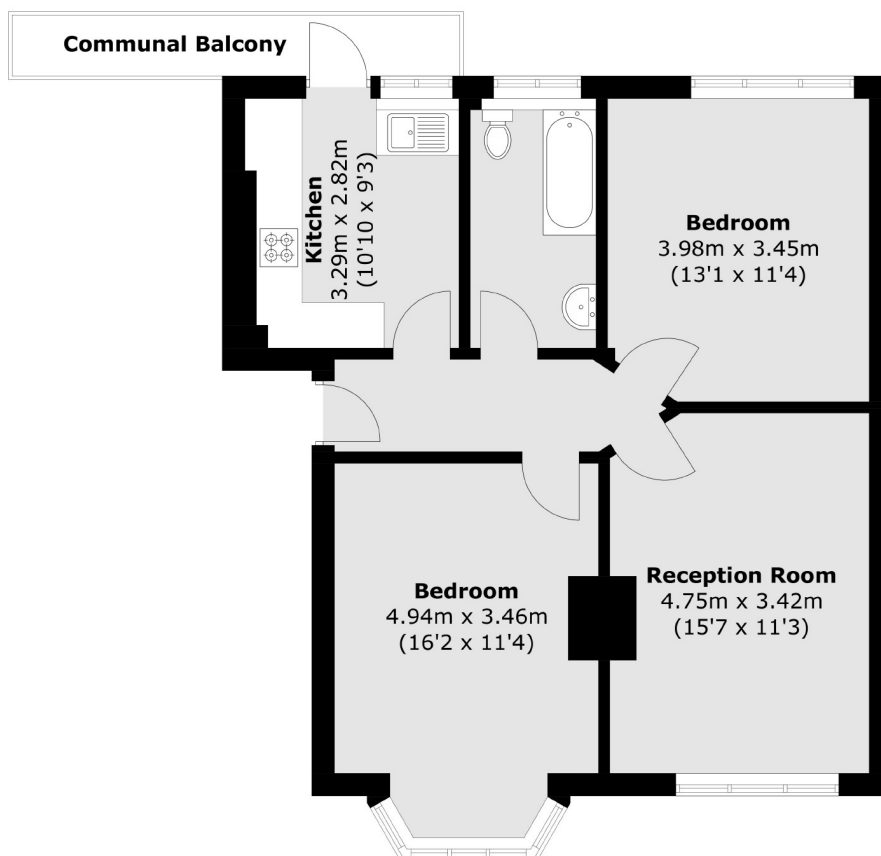

Total area (approx.): 68.5 sq. m (737.3 sq. ft)
Communal Balcony: 4.7 sq. m (50.6 sq. ft)

Jacksons Streatham
1-3 De Montfort Parade
Streatham High Road
Streatham
London
SW16 1BU

Energy Rating: We aim to make our particulars both accurate and reliable. However they are not guaranteed; nor do they form part of an offer or contract. If you require clarification on any points then please contact us, especially if you're traveling some distance to view. Please note that appliances and heating systems have not been tested and therefore no warranties can be given as to their good working order.