



ABERCAIRN ROAD, SW16

£650,000

- Three bedrooms
- South facing garden
- Close to station
- Excellent condition
- Potential to extend
- Energy rating: D







## ABOUT THE HOME

A very well presented, three bedroom family home with a south facing garden backing onto Eardley Road nature reserve.

Abercairn is very conveniently placed at the northern end of Streatham Vale affording easy access to Streatham Common station. Being close to the green open spaces of Streatham common and within easy walking distance of Greyhound lane with its developing mini high street. Commuters can access bus routes into Brixton and beyond from Streatham High Road and swift connections from Streatham common station to London Victoria & London Bridge. You are also walking distance away from Streatham Station offering Thameslink services.







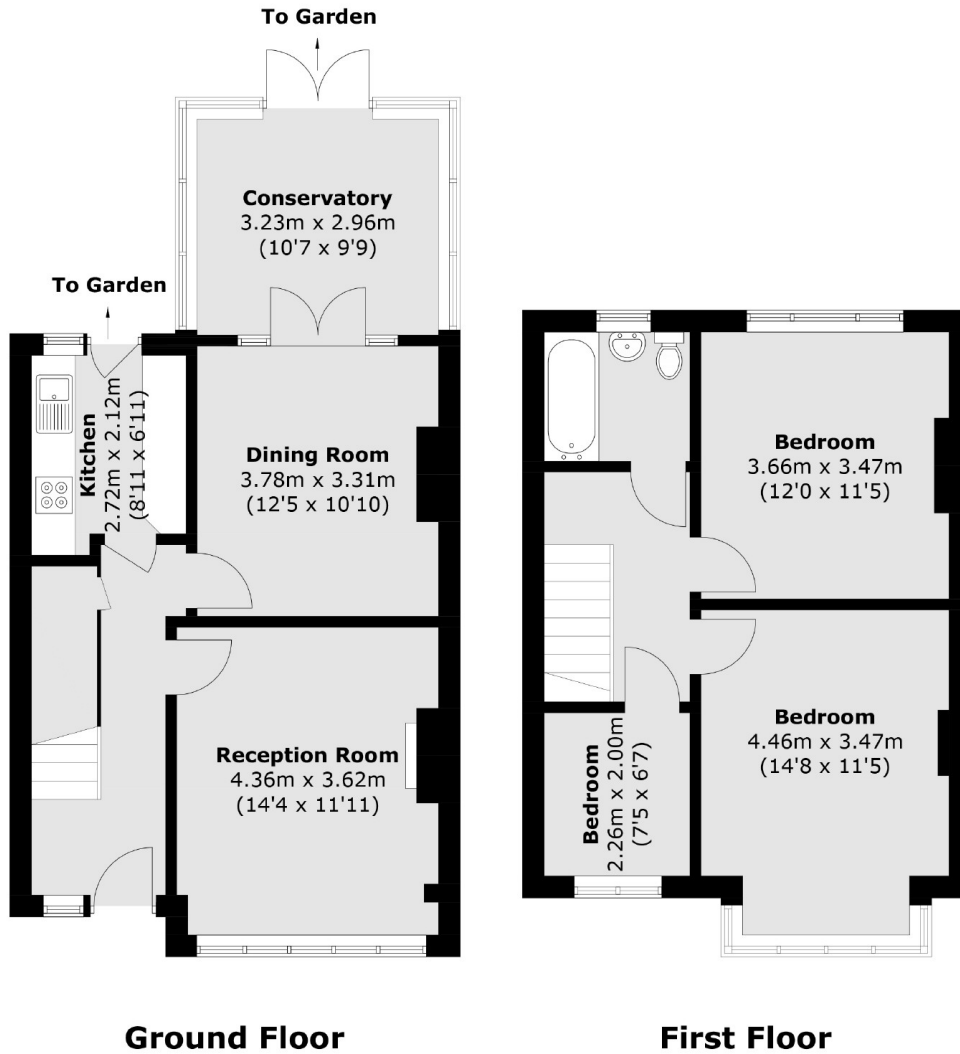

Total area (approx.): 97.7 sq. m (1,051.6 sq. ft)

#### JACKSONS STREATHAM

1-3 De Montfort Parade,  
Streatham High Road,  
Sales: 020 8487 3179  
Lettings: 020 8487 3180

Energy Rating: D We aim to make our particulars both accurate and reliable. However they are not guaranteed; nor do they form part of an offer or contract. If you require clarification on any points then please contact us, especially if you're traveling some distance to view. Please note that appliances and heating systems have not been tested and therefore no warranties can be given as to their good working order.