



Guildersfield Road, SW16

£3,000 PCM

A newly refurbished three bedroom house, arranged over two floors, offers a bright and spacious reception room, a dining room with direct access to a large private garden, a modern kitchen, and three well-proportioned double

- Modern house
- Newly refurbished throughout
- Three double bedrooms
- Large garden
- Close to the common and the Rookery Gardens
- Short walk to amenities and

For further information on the costs associated with renting a property, please pop into our office or visit our website.



Guildersfield, a tree lined street running off Streatham common itself is located in a quiet conservation area within very close proximity of the main amenities of Streatham High Street including the Streatham hub leisure centre, restaurants, bars, café's and two large supermarkets. The property is also a short distance from the open spaces of the Rookery Gardens and Norwood Grove. Local transport includes Streatham with swift links to London Bridge and Streatham Common with links to Victoria via Clapham Junction



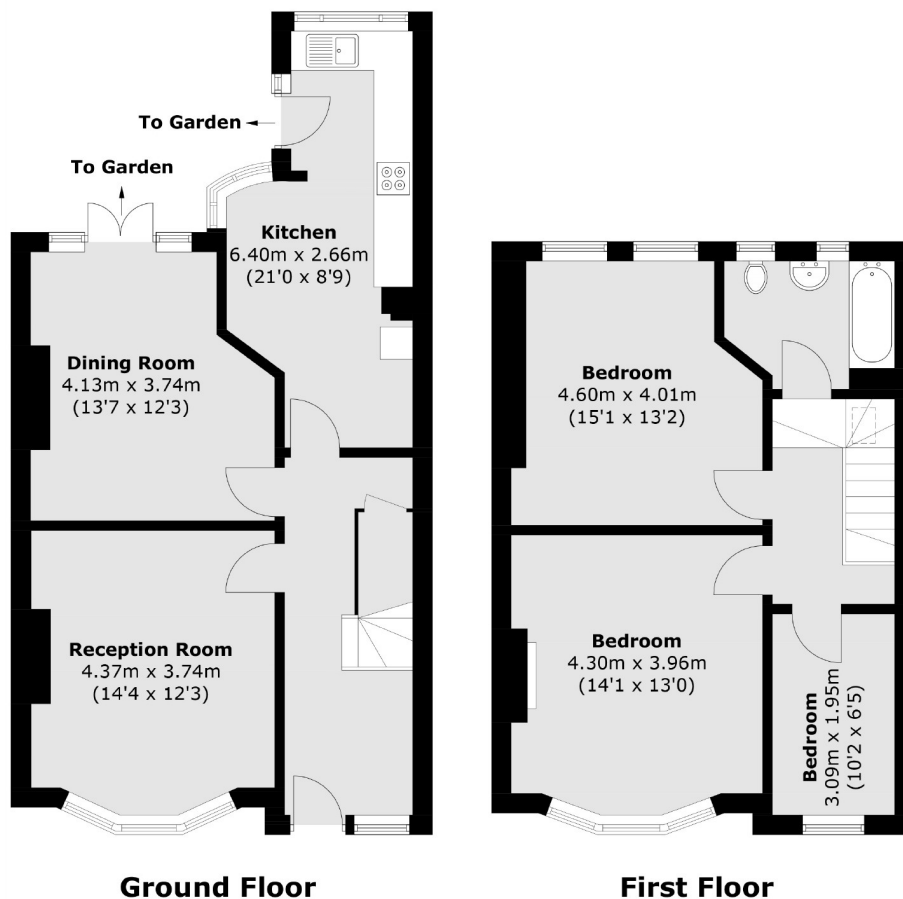

Total area (approx.): 106.3 sq. m (1,144.2 sq. ft)

Jacksons Streatham
1-3 De Montfort Parade
Streatham High Road
Streatham
London
SW16 1BU

Energy Rating: D We aim to make our particulars both accurate and reliable. However they are not guaranteed; nor do they form part of an offer or contract. If you require clarification on any points then please contact us, especially if you're traveling some distance to view. Please note that appliances and heating systems have not been tested and therefore no warranties can be given as to their good working order.