



HENRY DOULTON DRIVE, SW17

£700,000

- Freehold House
- Private Development
- Adjoining Garage
- No Onward Chain
- Three Double Bedrooms
- Double Reception Room







## ABOUT THE HOME

A spacious three double bedroom home located in the highly sought after Heritage Park development. This well presented property is offered with no onward chain and benefits from allocated residents' parking and comes with a garage. Internally, the home offers a bright and large living space. The ground floor features a large double reception room, providing ample space for both seating and dining areas, along with a separate fitted kitchen. From here, there is direct access to a generously sized rear garden with the added convenience of rear access in to the garage. The location offers a blend of urban convenience and green space, with Tooting Bec Underground Station (on the Northern Line) just a short distance away, providing quick access to central London. Additionally, Tooting High Street is nearby, offering a vibrant selection of shops, cafes, restaurants, and bars. This area is known for its strong community feel, excellent local schools, and the abundance of parks and outdoor spaces, making it a popular choice for families and professionals alike.







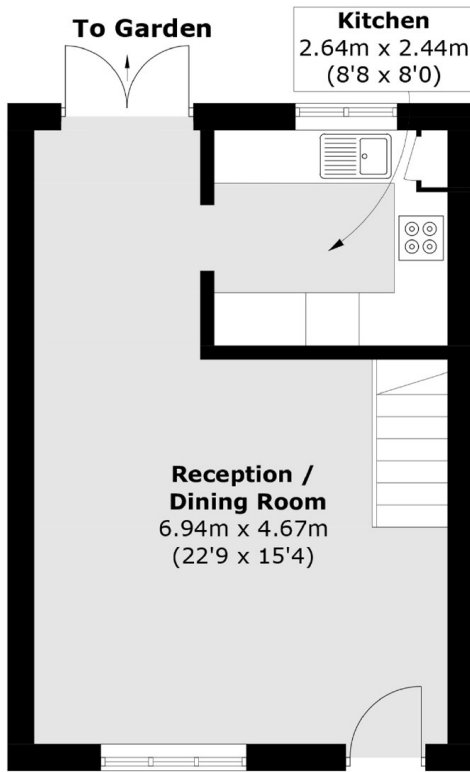

**Ground Floor**

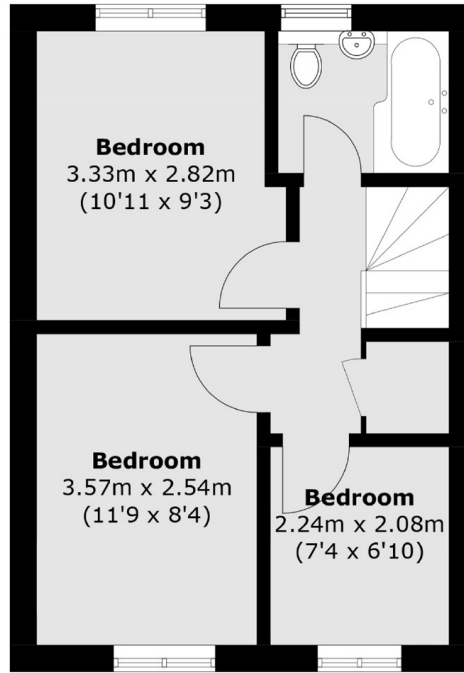

**First Floor**

**(Not Shown In Actual Location / Orientation)**

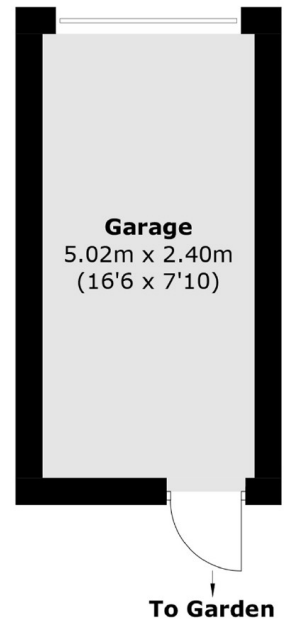

Total area (approx.): 65.1 sq. m (700.7 sq. ft)  
Garage: 12.2 sq. m (131.3 sq. ft)

#### **JACKSONS TOOTING**

3 Upper Tooting Road, London,  
SW17 7TS  
Sales: 020 8487 3175  
Lettings: 020 8487 3176

Energy Rating: We aim to make our particulars both accurate and reliable. However they are not guaranteed; nor do they form part of an offer or contract. If you require clarification on any points then please contact us, especially if you're traveling some distance to view. Please note that appliances and heating systems have not been tested and therefore no warranties can be given as to their good working order.