



PLUM MEWS, SW17

£675,000

- Three Bedrooms
- Two Bathrooms
- Wandsworth Common
- Ground Floor
- Maisonette
- Allocated Parking





ABOUT THE HOME

A stunning three bedroom ground floor maisonette set in the highly desirable Springfield Place development. There is a stylish open plan kitchen/reception room, three double bedrooms, two bathrooms with access onto a private garden. Complete with an allocated parking space, a long lease and an NHBC building guarantee.

Plum Mews is apart of the wider Springfield Place development of exemplary homes in the heart of Tooting Bec and Wandsworth Common. The vast amenities of both Balham and Tooting Town centres are nearby with easy access to bus and transport links via Tooting Bec and Tooting Broadway Tube Stations. As well as Wandsworth Common and Earlsfield National Rail Stations providing connections into Central London.





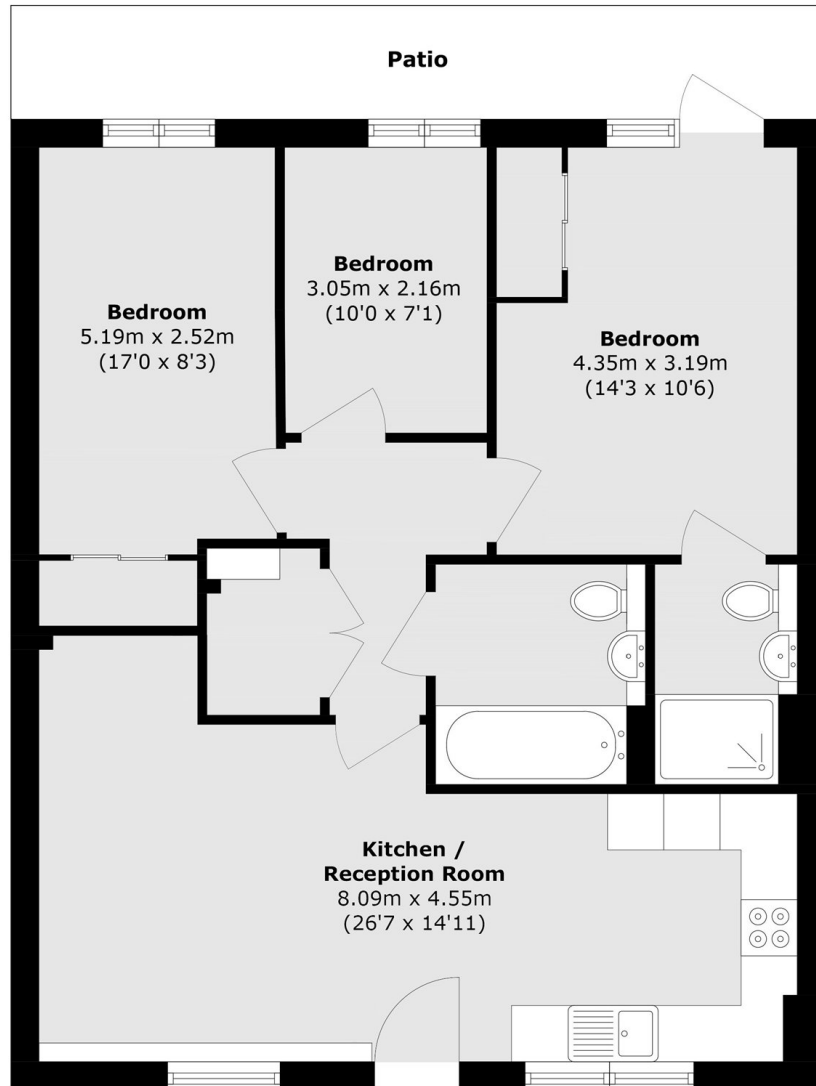

Total area (approx.): 78.9 sq. m (849.2 sq. ft)

JACKSONS TOOTING

3 Upper Tooting Road, London,

SW17 7TS

Sales: 020 8487 3175

Lettings: 020 8487 3176

Energy Rating: We aim to make our particulars both accurate and reliable. However they are not guaranteed; nor do they form part of an offer or contract. If you require clarification on any points then please contact us, especially if you're traveling some distance to view. Please note that appliances and heating systems have not been tested and therefore no warranties can be given as to their good working order.