



## Oak Crescent, E16

### £600,000

We are pleased to present this four-bedroom freehold house to the market, ideally located just moments from Canning Town station. The property further benefits from a private garden, permit parking, and is offered on a chain-free basis.

Oak Crescent is conveniently located just 0.4 miles from Canning Town station, providing excellent transport links across the City.

### Features

- 1,197 Square Feet
- Private Garden
- Freehold House
- Four Double Bedrooms
- Permit Parking
- Chain Free

# Oak Crescent, London, E16

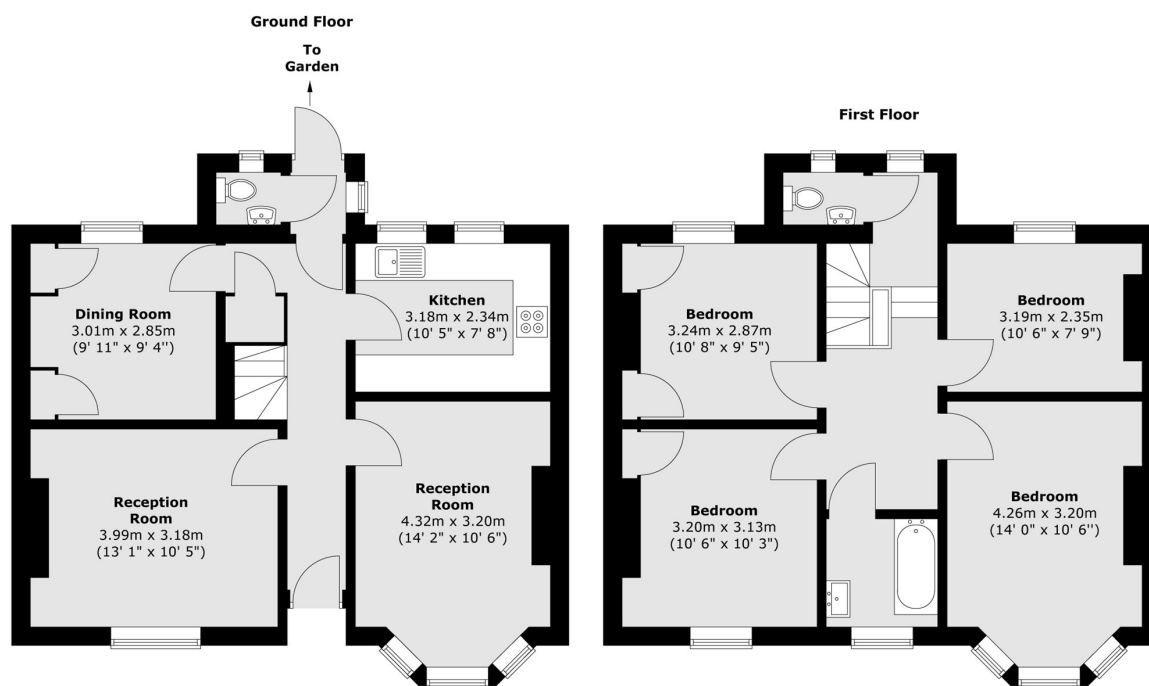

Total area (approx.) : 111.2 sq. m (1197 sq. ft)

## Dexters

Wapping  
123 Wapping High Street  
London  
E1W 3NX

Sales  
020 7650 5350

Energy Rating: C. We aim to make our particulars both accurate and reliable. However they are not guaranteed; nor do they form part of an offer or contract. If you require clarification on any points then please contact us, especially if you're traveling some distance to view. Please note that appliances and heating systems have not been tested and therefore no warranties can be given as to their good working order.

 **RICS** | Regulated  
Estate Agent  
and Letting Agent

[dexters.co.uk](https://www.dexters.co.uk)