



## Knights Road, E16

### £300,000

Situated within a modern and highly sought-after development in the heart of the Royal Docks, this beautifully presented one-bedroom apartment offers stylish contemporary living with excellent transport connections and superb resident amenities.

The property features a spacious open-plan living and dining area, complemented by a modern fitted kitchen and direct access to a private balcony. The double bedroom is well-proportioned, while the contemporary bathroom is finished to a high standard.

A particular highlight of the apartment is the abundance of built-in storage throughout, offering practical and versatile living space rarely found in comparable one-bedroom properties. Residents also benefit from access to an impressive communal roof terrace, ideal for enjoying panoramic views across the surrounding area.

West Silvertown DLR Station is approximately 0.1 miles from the property (around a 2-minute walk), providing swift access to Canary Wharf, Stratford and Bank. Custom House Station (Elizabeth Line and DLR) is approximately 0.6 miles away, offering fast connections to the City, West End and Heathrow Airport.

### Features

- Chain Free
- Modern one-bedroom apartment
- Private balcony
- Spacious open-plan living area
- Contemporary fitted kitchen
- Built-in storage throughout
- Communal roof terrace

# Knights Road, London, E16

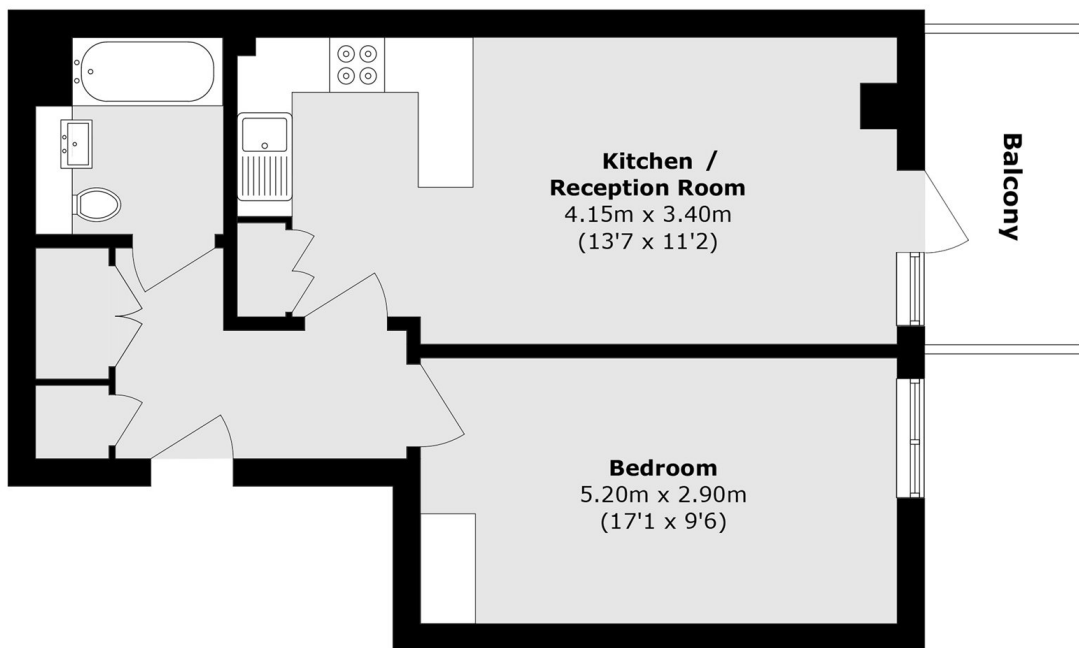

Total area (approx.): 51.6 sq. m (555.4 sq. ft)

Balcony area (approx.): 5.7 sq. m (61.3 sq. ft)