



FOR SALE

3 Bed Semi-Detached House in Southfields Avenue, Oadby, LE2 5GL
Offers Over £300,000

A neatly presented, chain-free three-bedroom semi-detached home in the highly sought-after location of Oadby, close to the racecourse. Set on a generous plot, the property benefits from a converted attic space and tidy presentation throughout. Contact Phillips George to arrange your viewing.



GROUND FLOOR
470 sq.ft. (43.7 sq.m.) approx.

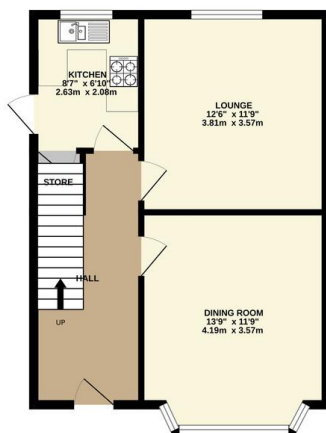

1ST FLOOR
457 sq.ft. (42.5 sq.m.) approx.

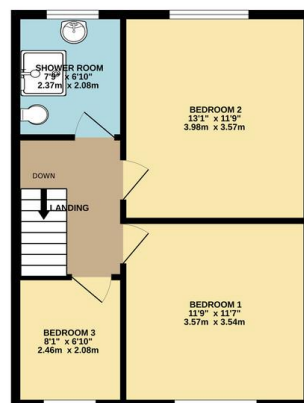

TOTAL FLOOR AREA: 928 sq.ft. (86.2 sq.m.) approx.
While every attempt has been made to ensure the accuracy of the description contained here, measurements of doors, windows, rooms and any other items are approximate and no responsibility is taken for any error, omission or misstatement. This plan is for illustrative purposes only and should be used as such by any prospective purchaser. The services, systems and appliances shown have not been tested and no guarantee as to their operability or efficiency can be given.
Made with Metrepro ©2025

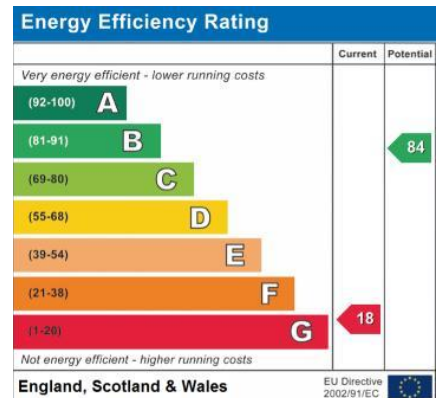

- Semi Detached
- Three Bedroom
- No Upward Chain
- Oadby
- Highly Popular Location
- Landscaped Gardens
- Off Road Parking
- Converted Attic Space

Agents Note: Whilst every care has been taken to prepare these sales particulars, they are for guidance purposes only. All measurements are approximate are for general guidance purposes only and whilst every care has been taken to ensure their accuracy, they should not be relied upon and potential buyers are advised to recheck the measurements.

