



P U T T E R I L L S

est. 1992

Ashley Road, St. Albans, AL1 5NT

Guide price £365,000

Located just over one mile from St Albans station is this two bedroom terrace home offered in superb condition throughout.

Nestled away in a quiet cul-de-sac is this superb two double bedroom terrace home. A fantastic opportunity for first time buyers and those looking to upsize from apartments alike, this property should be viewed to appreciate its deceptively spacious accommodation. Located just over one mile for the mainline station, it is also within easy walking distance of excellent local amenities, parks and countryside walks.

Downstairs you enter via a small hallway into the welcoming open plan living and dining room with dual aspect windows allowing light to fill the room. Double doors lead through to the large conservatory which enjoys views over the well maintained rear garden. The fitted kitchen with a good selection of wall and base units finishes the ground floor.

Upstairs there are two excellent sized bedrooms which served by the fitted bathroom.

The property further benefits from a beautifully landscaped private rear garden and a garage en bloc.







Ground Floor

Approx. 49.8 sq. metres (536.5 sq. feet)

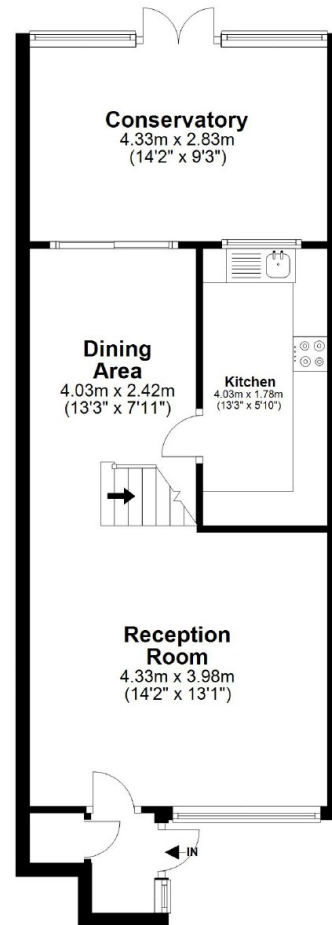

First Floor

Approx. 34.0 sq. metres (365.6 sq. feet)

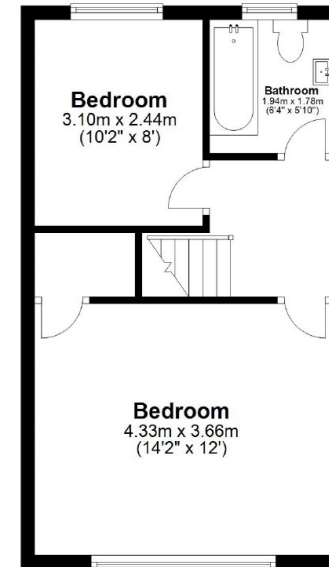

Total area: approx. 83.8 sq. metres (902.1 sq. feet)

Plan and measurements are for guidance only.

Plan produced using PlanUp.



PUTTERILLS

EST. 1992

putterills.co.uk | 01727 225858 | stalbans@putterills.co.uk

You may download, store and use the material for your own personal use and research. You may not republish, retransmit, redistribute or otherwise make the material available to any party or make the same available on any website, online service or bulletin board of your own or of any other party or make the same available in hard copy or in any other media without the website owner's express prior written consent. The website owner's copyright must remain on all reproductions of material taken from this website.