



Winterburn Close, N11

£650,000

Located on a quiet cul-de-sac is this modern build house available on a chain free basis. This property comprises of three bedrooms, a large shared bathroom, guest w/c, a spacious reception room with a separate kitchen allowing direct access out to a private rear garden. This property also benefits from off street parking.

Winterburn Close is a sought after residential location, running just off Colney Hatch Lane, providing excellent access to Muswell Hill, Friern Barnet and New Southgate, which means a lovely selection of local shops and transport links into Central London.

Features

- Three Bedrooms
- Cul-De-Sac
- Driveway
- Double Glazing
- Chain Free
- Transport Links

Winterburn Close, London, N11

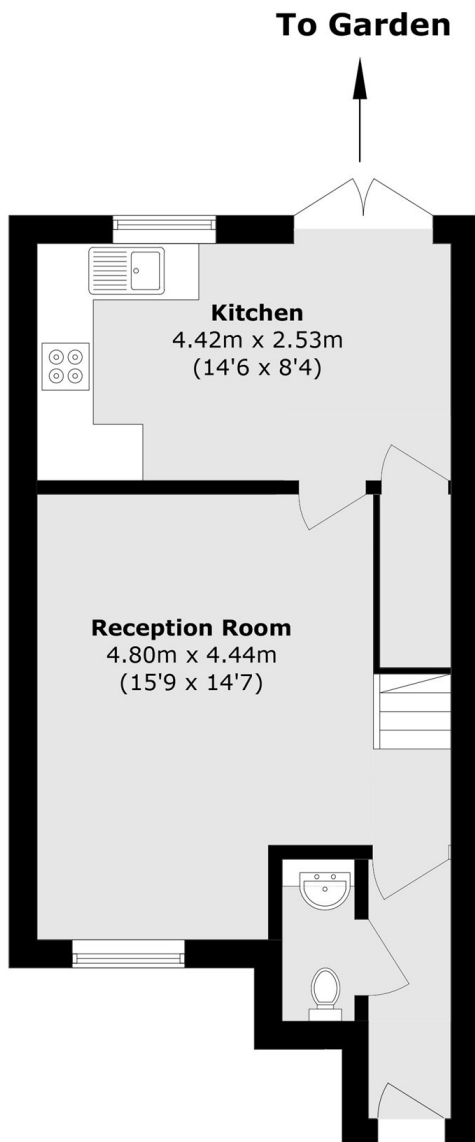

Ground Floor

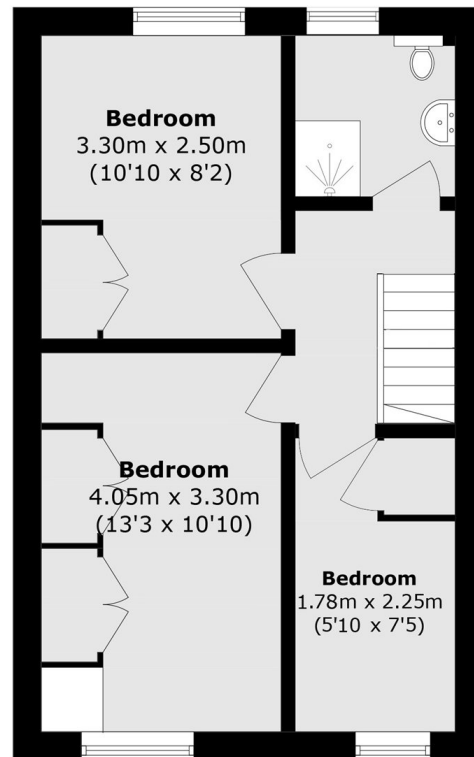

First Floor

Total area (approx.): 68.2 sq. m (734.1 sq. ft)