



Empire Square, N7

£425,000

Situated on the first floor of a contemporary block within a gated development, this property offers two en suite double bedrooms, a large semi-open plan kitchen/ reception room, and a private balcony.

Located close to Whittington Park and within a mile of Tufnell Park (Northern line) and Holloway Road (Piccadilly line) stations. Local bus access can also be found nearby on Holloway Road.

Features

- Two Double Bedrooms
- Two Bathrooms
- Balcony
- Bike Storage
- Gated Development
- Good Transport Links

Empire Square, London, N7

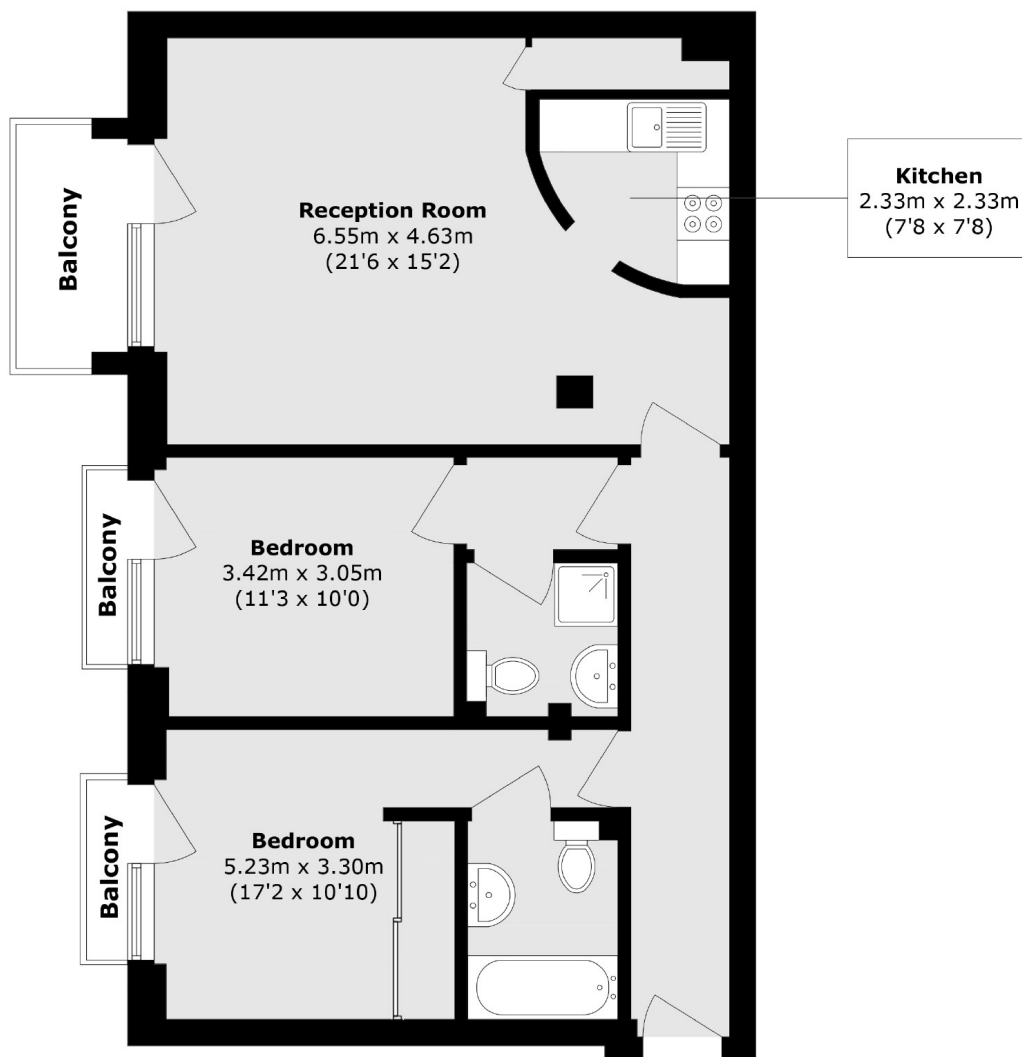

Total area (approx.): 73.4 sq. m (790.0 sq. ft)

Balcony area (approx.): 5.3 sq. m (57.0 sq. ft)

Dexters

Dartmouth Park & Tufnell Park
64 Chetwynd Road
Dartmouth Park
London

Sales
020 7284 0101

Energy Rating: C. We aim to make our particulars both accurate and reliable. However they are not guaranteed; nor do they form part of an offer or contract. If you require clarification on any points then please contact us, especially if you're traveling some distance to view. Please note that appliances and heating systems have not been tested and therefore no warranties can be given as to their good working order.

 **RICS** | Regulated
Estate Agent
and Letting Agent

[dexters.co.uk](https://www.dexters.co.uk)