



Shoot Up Hill, NW2

£285,000

On the first floor of this popular art-deco building is this bright one bedroom apartment spanning over 500 sq ft. The property will be sold with no onward chain, making it perfect for first time buyers or investors.

Located on Shoot Up Hill, the property is ideally positioned for commuters being within walking distance of both Kilburn tube station (Jubilee Line) and Brondesbury Overground station. Multiple amenities are found nearby at Mill Lane, West End Lane, and Kilburn High Road.

Features

- One Bedroom
- First Floor
- No Chain
- Separate Kitchen
- Close To Station
- Lift Access

Shoot Up Hill, London, NW2

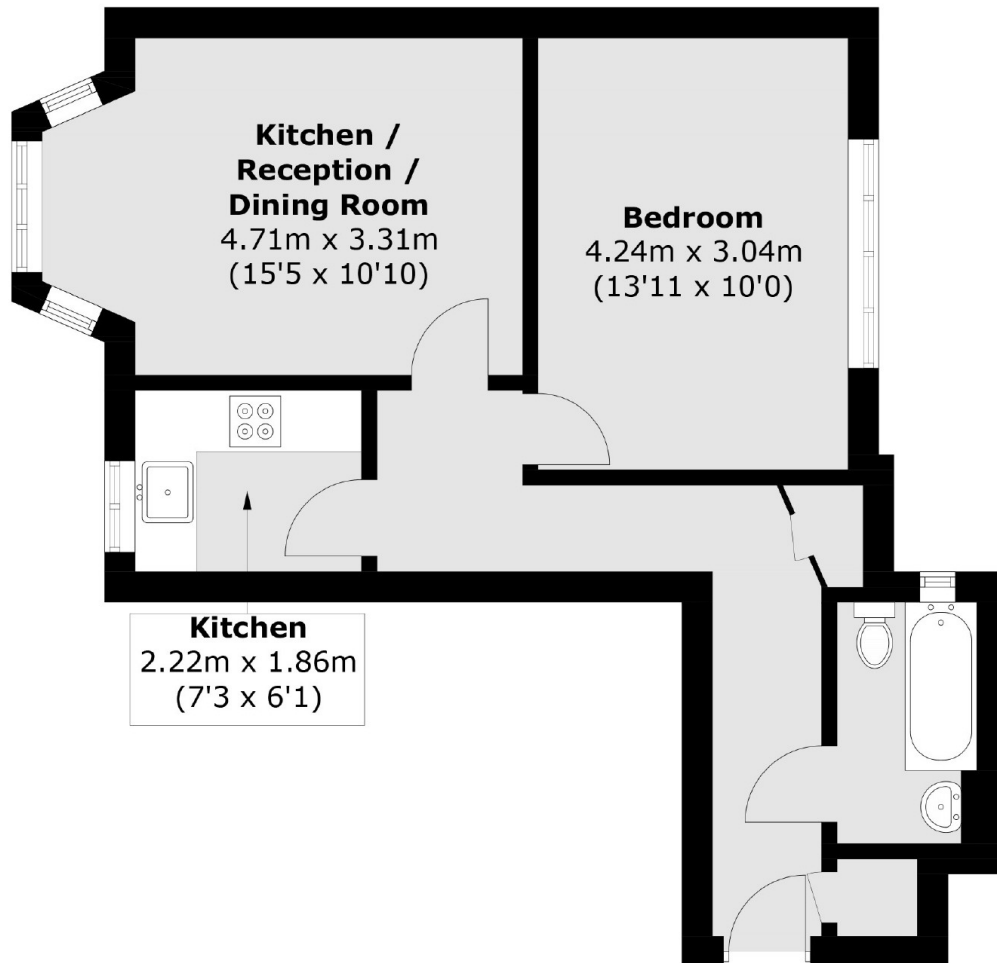

Total area (approx.): 47.0 sq. m (505.9 sq. ft)

Dexters

West Hampstead Sales
349 West End Lane
London
NW6 1LT
Sales
020 7644 9300

Energy Rating: C. We aim to make our particulars both accurate and reliable. However they are not guaranteed; nor do they form part of an offer or contract. If you require clarification on any points then please contact us, especially if you're traveling some distance to view. Please note that appliances and heating systems have not been tested and therefore no warranties can be given as to their good working order.

 **RICS** | Regulated
Estate Agent
and Letting Agent

[dexters.co.uk](https://www.dexters.co.uk)