



Heath Street, NW3

£1,999 Per calendar month

A large and beautifully presented studio apartment set on the first floor of this purpose built block in the heart of Hampstead Village.

Located in the heart of Hampstead with its boutique shops and restaurants on your doorstep. Hampstead Heath is half a mile around the corner.

Features

- First Floor
- Studio
- Wood Floor Throughout
- Separate Kitchen
- Village Location
- Bright

Heath Street,
London, NW3

First Floor

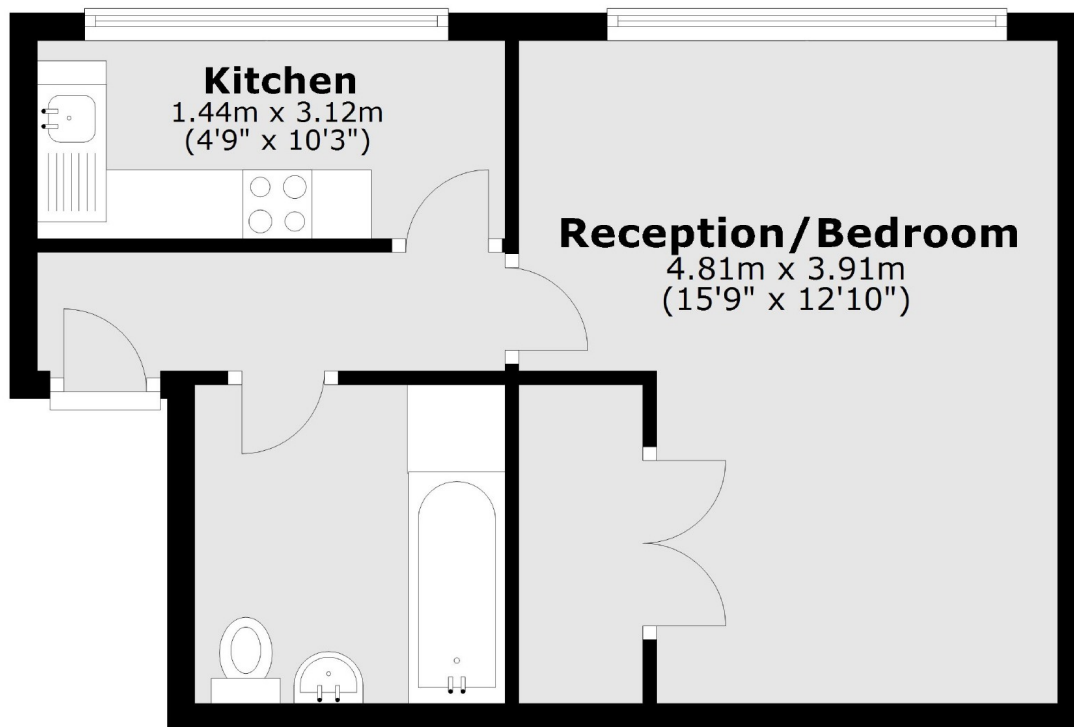

Total area: approx. 32.8 sq. metres (353.5 sq. feet)