



Loudoun Road, NW8

£700,000

A beautifully presented two bedroom fifth floor flat located within this purpose built block on Loudoun Road. The flat offers a spacious reception room with open plan kitchen and direct access to a private south facing balcony. There are two good size bedrooms and a family bathroom. The flat offers triple glazing, airflow heating system and Amtico flooring in the living areas.

Loudoun Road is excellently located close to South Hampstead Station, a five minute walk to Swiss Cottage Station and a twelve minute walk to St John's Wood Underground Station.

Features

- Fifth Floor
- Two Bedrooms
- South Facing Balcony
- Triple Glazing
- Convenient Location
- Large Reception Room

Loudoun Road, London, NW8

Fifth Floor

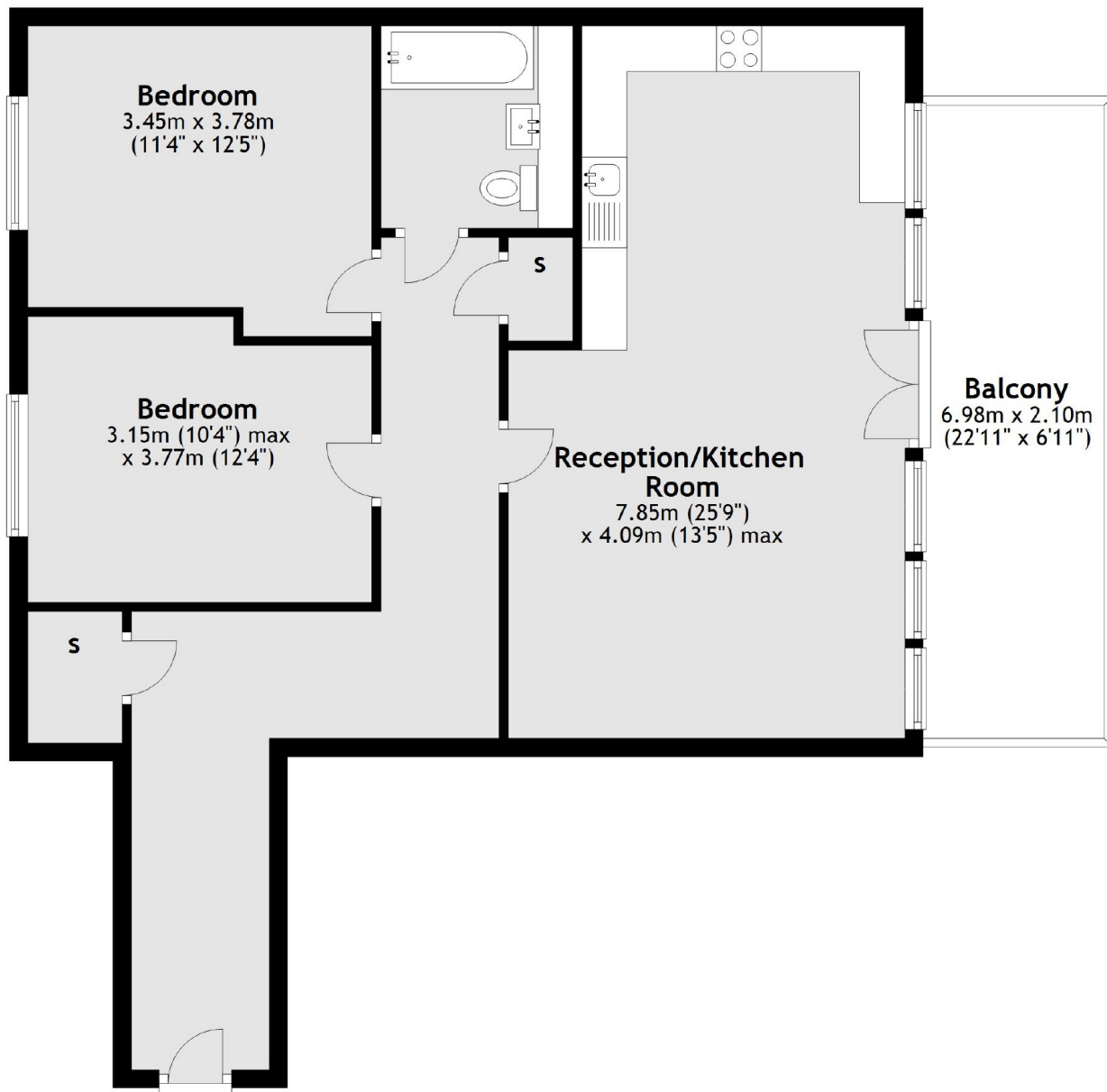

Total area: approx. 79.0 sq. metres (850.7 sq. feet)