

Hall Road, NW8

£365,000

A one-bedroom ground-floor flat in a portered building in NW8, offered chain-free on a 52-year lease. The property features a spacious living room, a sleek separate kitchen, a comfortable bedroom and a modern bathroom - great location.

Located in the heart of St John's Wood, the area offers a blend of village charm and city convenience, with boutique shops, cafés, and restaurants moments away. Regent's Park and Primrose Hill provide exceptional green space within easy walking distance. Excellent transport links are available via St John's Wood Underground Station (Jubilee Line).

Features

- One Bedroom
- Chain Free
- Porter
- 52 Year Lease
- Approximately 525 Sq.Ft
- Good Condition

Hall Road, London, NW8

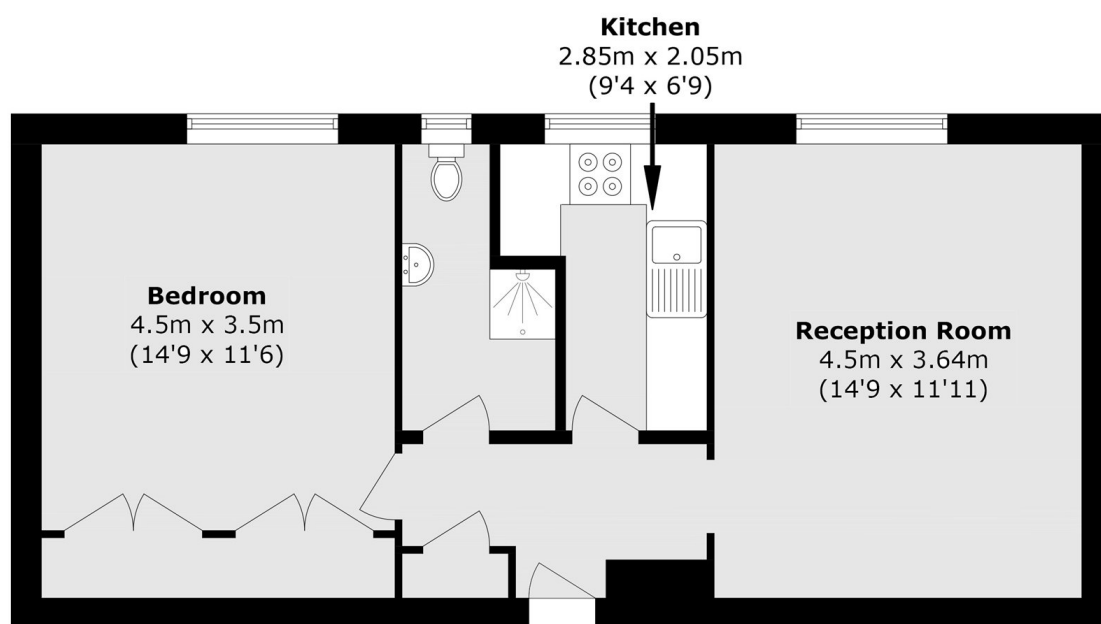

Total area (approx.): 46.3 sq. m (498.3 sq. ft)