

Aylmer Parade, N2

£315,000

A well presented first floor flat with wooden flooring to the reception room, a modern semi-open plan kitchen and good size double bedroom.

Conveniently placed between both Highgate and East Finchley tube stations, the property is well positioned for access to the local woodland and convenience stores.

Features

- Double Bedroom
- Kitchen
- En Suite Bathroom
- Double Glazing
- Close To Transport
- Long Lease

Aylmer Parade, London, N2

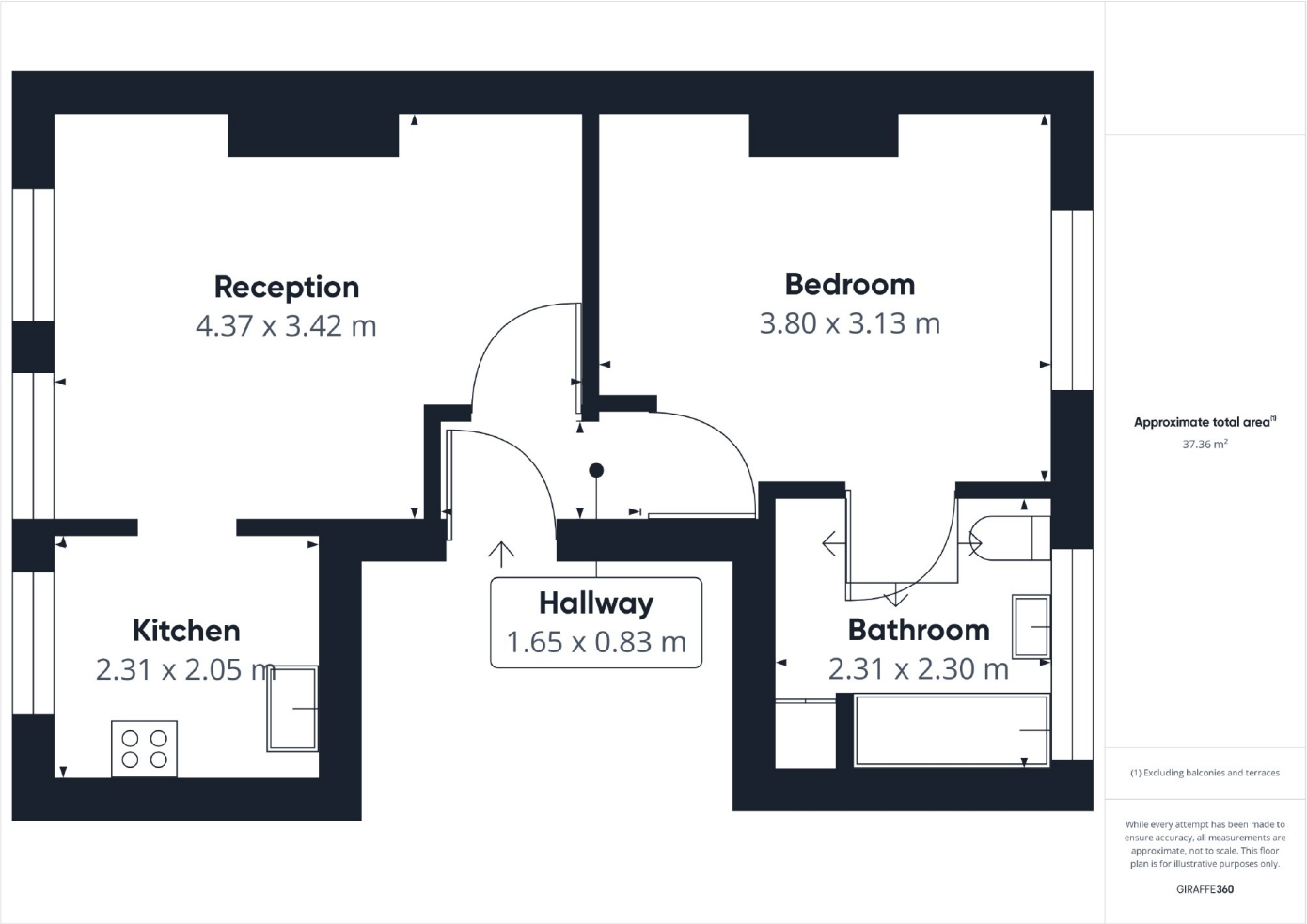

Dexters

Highgate
35A Highgate High Street
London
N6 5JT
Sales
020 8545 8584

Energy Rating: C. We aim to make our particulars both accurate and reliable. However they are not guaranteed; nor do they form part of an offer or contract. If you require clarification on any points then please contact us, especially if you're traveling some distance to view. Please note that appliances and heating systems have not been tested and therefore no warranties can be given as to their good working order.

 **RICS** | Regulated
Estate Agent
and Letting Agent

dexters.co.uk