



Bloomfield Road, N6

£2,500 Per calendar month

A spacious two double bedroom flat set on the first floor of this purpose built block in Highgate. Both Living room and bedrooms are very bright with dual aspect windows and wood floor throughout.

Well located just 0.3 miles from Highgate Underground station with Highgate Village 0.5 miles away and with numerous local open spaces including Highgate Wood close by.

Features

- Two Double Bedrooms
- First Floor Flat
- Separate Kitchen
- Wood Floor Throughout
- Bright
- Great Location

Bloomfield Road,
London, N6

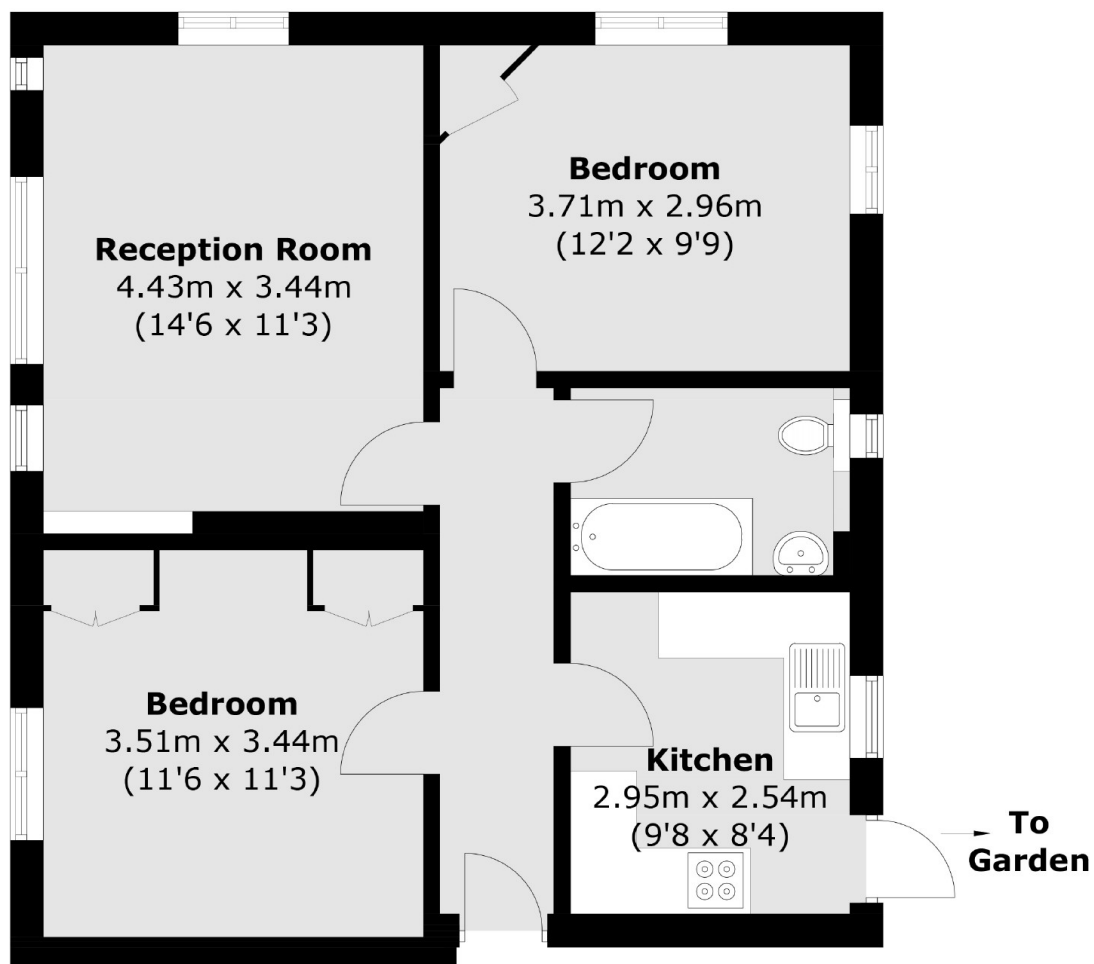

Total area (approx.): 58.5 sq. m (629.7 sq. ft)