



## Murray Street, NW1

£576 Per week

Just off the desirable Camden Square is this stunning two bedroom apartment. The property has been finished to an excellent standard throughout. There is also direct access to a private courtyard.

Murray Street, situated in the Camden Square conservation area, is superbly located close to the many amenities of bustling Camden Town, with Regent's Park and Primrose Hill within easy reach.

### Features

- Two Bedrooms
- One Bathroom
- Private Courtyard
- Great Location
- Great Transport Links
- Available Now

# Murray Street, London, NW1

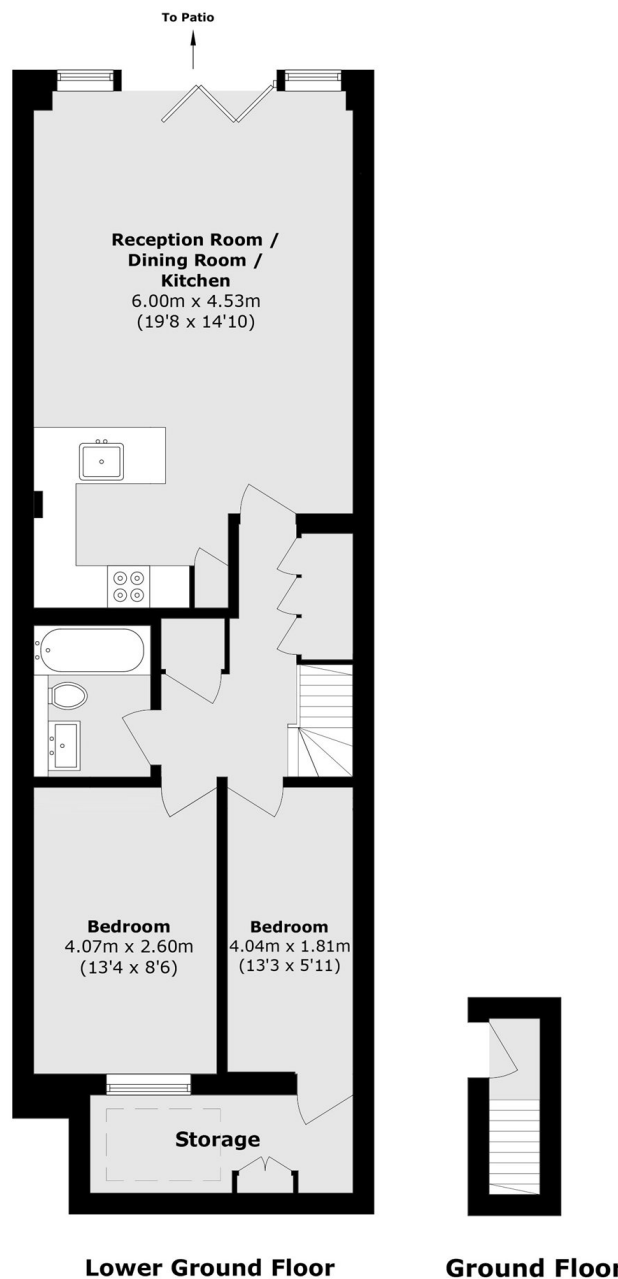

Total area (approx.): 71.6 sq. m (770.7 sq. ft)

## Dexters

Kentish Town & Camden  
274 Kentish Town Road  
London  
NW5 2AA  
Lettings  
020 7483 6391

Energy Rating: C. We aim to make our particulars both accurate and reliable. However they are not guaranteed; nor do they form part of an offer or contract. If you require clarification on any points then please contact us, especially if you're traveling some distance to view. Please note that appliances and heating systems have not been tested and therefore no warranties can be given as to their good working order.

 **RICS** | Regulated  
Estate Agent  
and Letting Agent

[dexters.co.uk](https://dexters.co.uk)