



## Coldershaw Road, W13

£425,000

**\*\*Offers in Excess\*\***

Two bedroom ground floor maisonette with a private garden.

Also comprises kitchen, living room and bathroom presented in good condition.

Well located within walking distance of the Elizabeth line at West Ealing station and also in easy reach of the Piccadilly line at Northfields Station.

Offered with long lease and no onward chain.

### Features

- Garden Flat
- Two Double Bedrooms
- Open-Plan Living Area
- Maisonette
- No Onward Chain
- Close to Elizabeth Line

# Coldershaw Road, London, W13

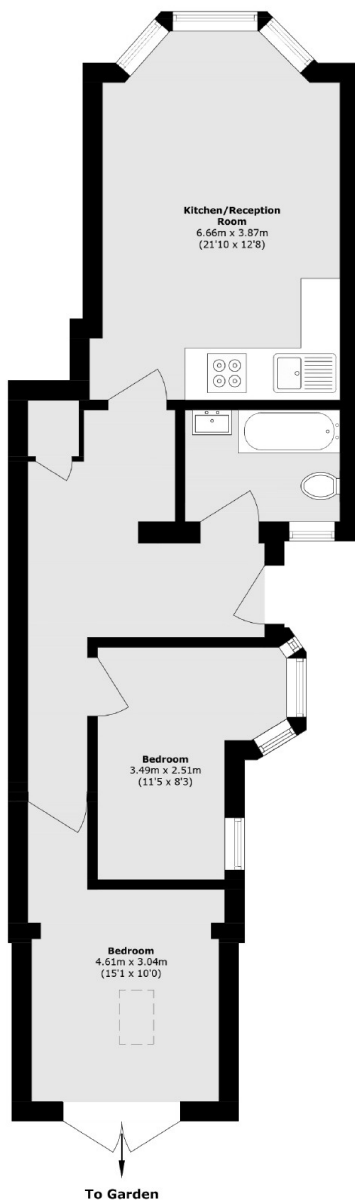

Total area (approx.): 58.3 sq. m (627.5 sq. ft)