



Westcott Crescent, W7

£475,000

This three bedroom end-of-terrace family home offers an excellent opportunity for modernisation and enjoys an enviable position backing onto Cuckoo Park.

Offered to the market with no onward chain, the property benefits from a larger-than-average rear garden, scope to extend (STPP) and a location that is notably closer to the station than similar homes nearby.

Approximately half a mile from the Elizabeth Line at Hanwell station and close to good school catchments including Ofsted outstanding Drayton Manor High School.

Features

- Three Bedrooms
- One Reception
- Modernisation Required
- No Onward Chain
- Large Garden
- Close to Schools and Transport

Westcott Crescent, London, W7

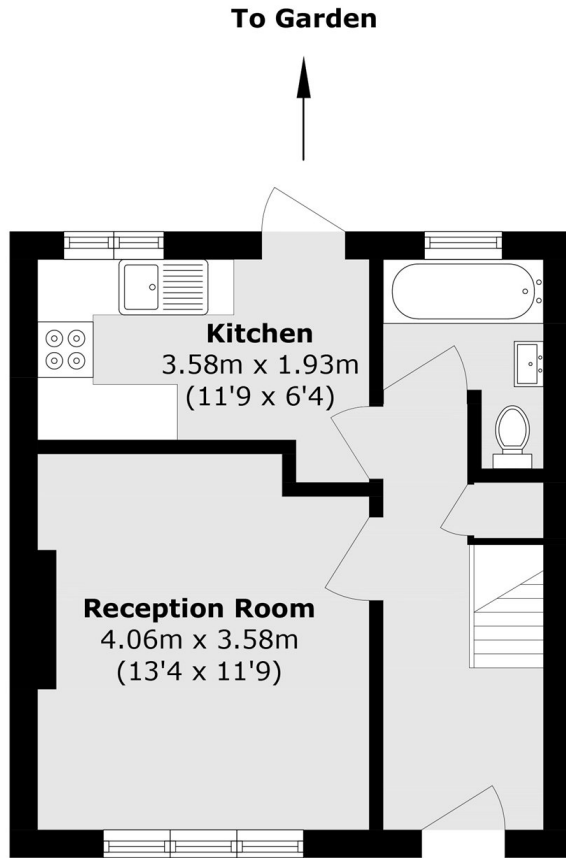

Ground Floor

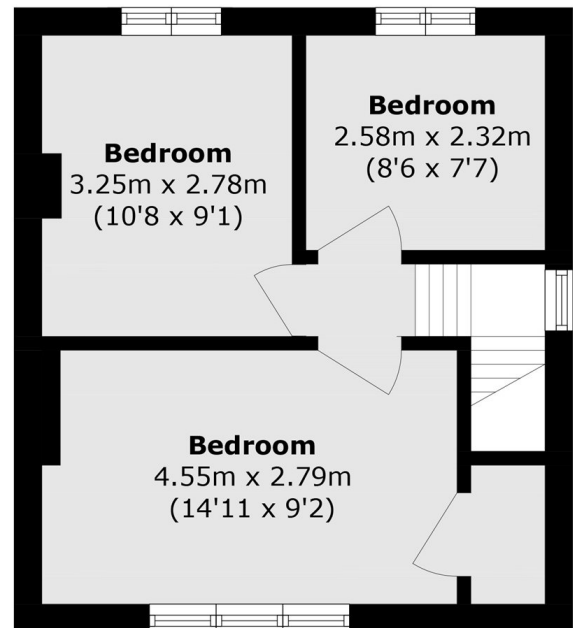

First Floor

Total area (approx.): 67.0 sq. m (721.2 sq. ft)