



## Linacre Road, NW2

### £525,000

This two bedroom, ground floor apartment is located within a desirable period building on a favourable residential road. The flat benefits from separate kitchen, living area with direct access to a private garden and comes with a long lease.

Linacre Road is a quiet one-way street close to Willesden Green and its great variety of cafes, shops and restaurants as well as transport links including Jubilee Line Tube Stations and numerous bus routes.

### Features

- Period Conversion
- Ground Floor
- Two Bedrooms
- Private Garden
- Long Lease
- Potential To Extend (STPP)

# Linacre Road, London, NW2

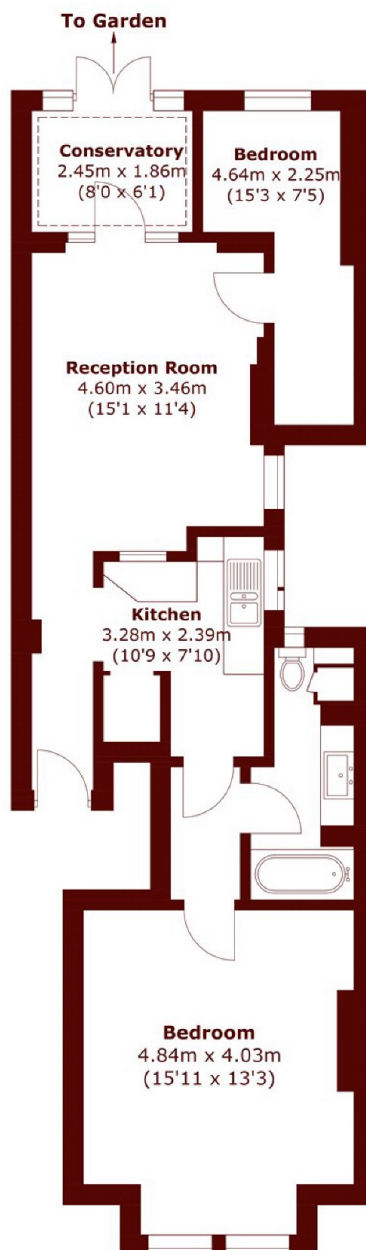

Total area (approx.): 66.7 sq. m (717.9 sq. ft)

## Dexters

Cricklewood  
28-30 Cricklewood Broadway  
London  
NW2 3HD  
Sales  
020 7794 7710

Energy Rating: . We aim to make our particulars both accurate and reliable. However they are not guaranteed; nor do they form part of an offer or contract. If you require clarification on any points then please contact us, especially if you're traveling some distance to view. Please note that appliances and heating systems have not been tested and therefore no warranties can be given as to their good working order.

 **RICS** | Regulated  
Estate Agent  
and Letting Agent

[dexters.co.uk](https://www.dexters.co.uk)