



## Queenstown Road, SW8

### £525,000

A two double bedroom lateral apartment situated on the sought after Queenstown Road measuring over 727 Sq Ft. Comprising an open plan reception/kitchen, two double bedrooms & two bathrooms (Inc en-suite). The property further benefits from allocated underground parking & is being sold chain free.

Queenstown Road is in the heart of the Diamond Conservation Area, close to the Battersea Power Station, ideally located for Battersea Park, Chelsea and convenient transport links via Battersea Park Road, Queenstown Road, as well as the Northern Line Extension. Clapham Common Underground is also a short stroll away.

### Features

- Open Plan Reception/Kitchen
- Two Double Bedrooms
- Two Bathrooms
- Allocated Underground Parking
- Measuring Over 727 Sq Ft
- Chain Free

# Queenstown Road, London, SW8

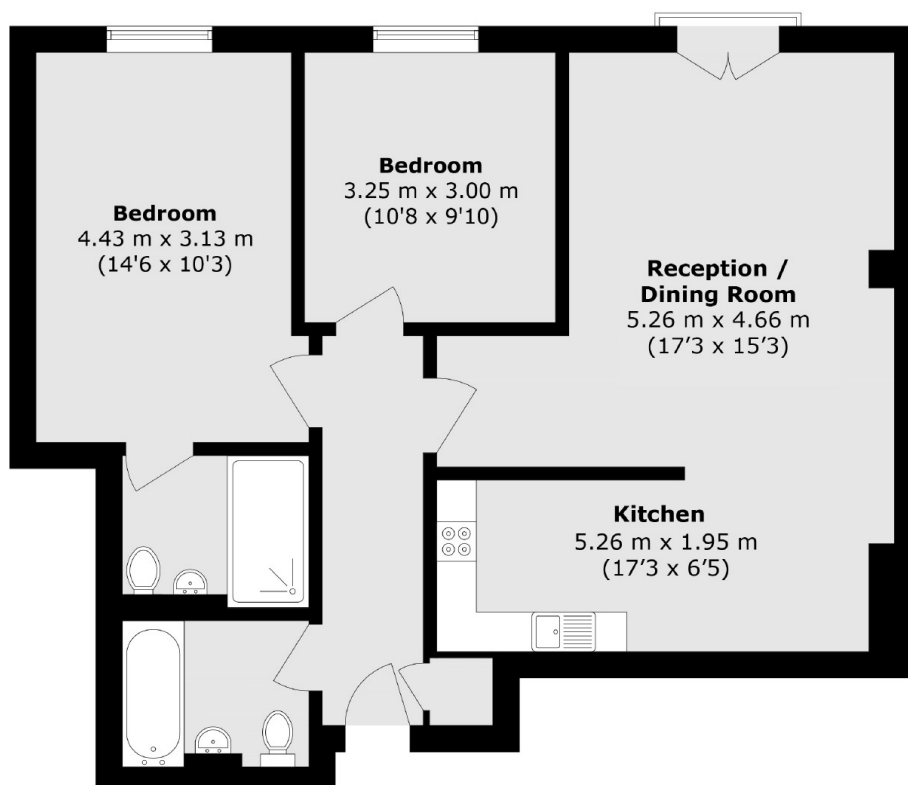

Total area (approx.): 67.6 sq. m (727.6 sq. ft)