



## Latchmere Road, SW11

£550,000

A beautiful two bedroom ground floor garden flat measuring circa 700 Sq Ft on the sought after Latchmere Road. Comprising a reception room, separate kitchen, two double bedrooms, family bathroom and private garden. The property benefits from secondary glazing and is being offered to the market chain free.

Latchmere Road is perfect for commuting from Clapham Junction into Central London and to Gatwick Airport. The green spaces of Clapham Common and Battersea Park are nearby, as are plenty of local pubs, restaurants, shops & gyms. The vibrant Northcote Road with it's amenities are also a short walk away.

### Features

Large Reception Room  
Two Double Bedrooms  
Separate Kitchen  
Family Bathroom  
Private Garden  
Chain Free

# Latchmere Road, London, SW11

## Ground Floor

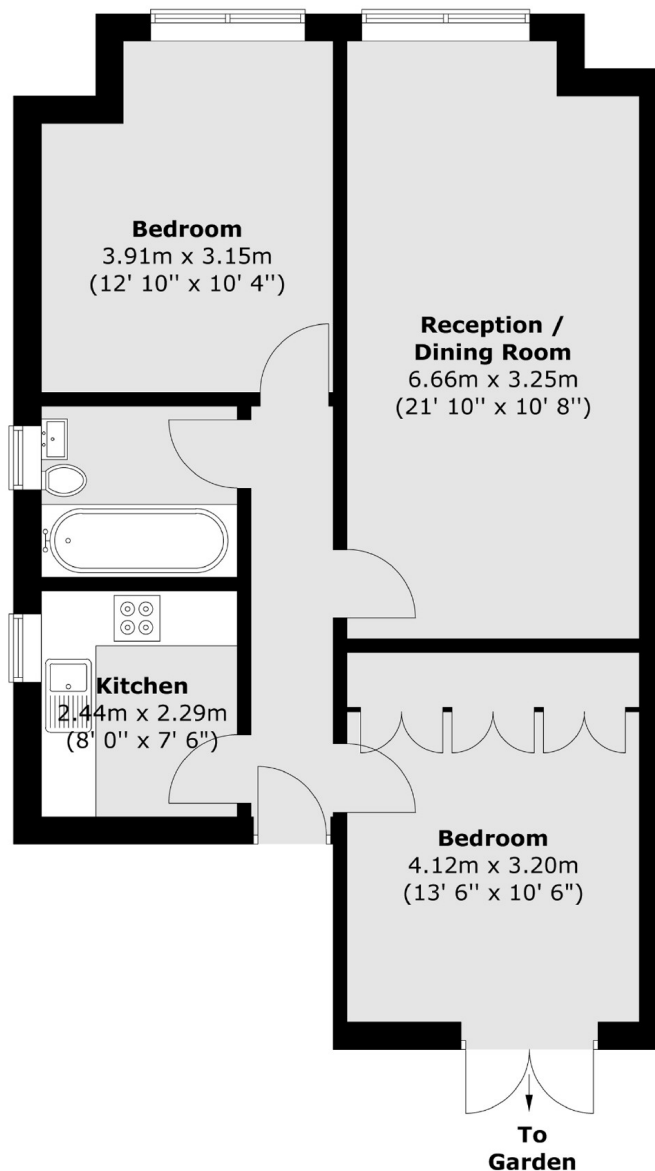

Total area (approx.) : 64.1 sq. m (689 sq. ft)

# Dexters

Northcote Road  
93 St. John's Road  
London  
SW11 1QY  
Sales  
020 7483 6333

Energy Rating: C. We aim to make our particulars both accurate and reliable. However they are not guaranteed; nor do they form part of an offer or contract. If you require clarification on any points then please contact us, especially if you're traveling some distance to view. Please note that appliances and heating systems have not been tested and therefore no warranties can be given as to their good working order.

 **RICS** | Regulated  
Estate Agent  
and Letting Agent

dexters.co.uk