



## Nantes Close, SW18

£375,000

An impressive, generously sized one-double-bedroom ground floor apartment measuring over 526 sq ft, ideally located on Nantes Close. The property features a reception room, a separate kitchen, a family bathroom and private garden. Additional benefits include an allocated parking space and the property is being sold chain free.

Nantes Close is a short stroll from St. Johns Hill with its excellent selection of shops, bars and restaurants and is located close to all of the amenities of Northcote Road as well. Clapham Junction is very close offering excellent mainline transport links.

### Features

- Large Reception Room
- One Double Bedroom
- Superb Location
- Private Garden
- Chain Free
- Allocated Parking

# Nantes Close, London, SW18

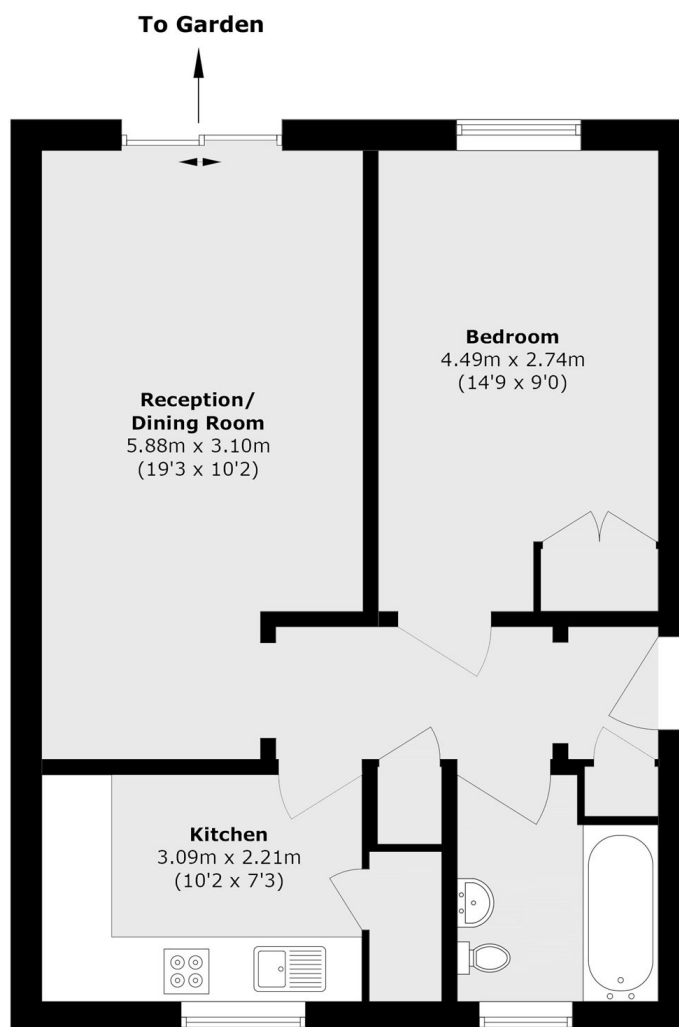

Total area (approx.): 48.9 sq. m (526.3 sq. ft)