



Theatre Street, SW11

£525,000

A two double bedroom apartment with direct access onto large communal gardens and allocated private parking located in the very heart of Clapham Junction.

The property is located on Theatre Street which is off Lavender Hill by the junction of Elspeth Road, so ideal for easy access to the Common, Battersea Rise and Northcote Road and not least Clapham Junction station.

Features

- 18ft Reception Room
- Separate Kitchen
- Two Double Bedrooms
- Communal Gardens
- Allocated Parking
- No Chain

Theatre Street, London, SW11

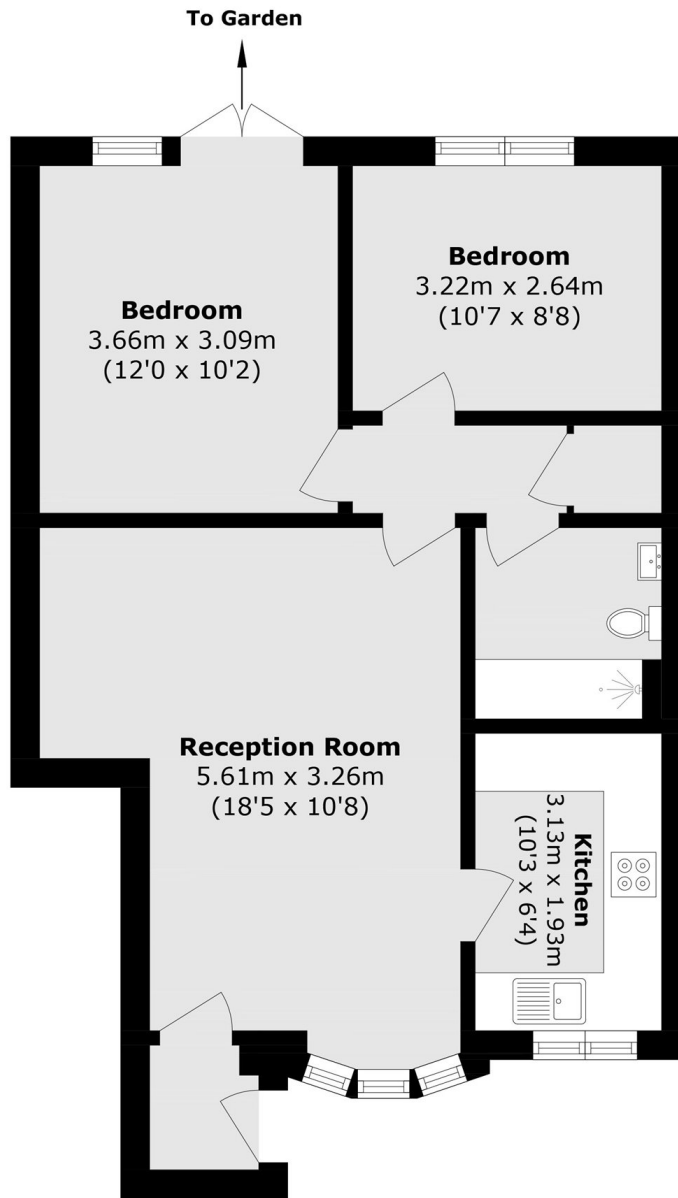

Total area (approx.): 56.6 sq. m (609.2 sq. ft)