



John Archer Way, SW18

£400,000

A beautifully presented bright and spacious, modern one double bedroom purpose built apartment. It has a reception room, separate kitchen with integrated appliances, double bedroom and family bathroom. Permit parking is available.

John Archer Way is located within a quiet cul-de-sac development overlooking Wandsworth Common and within a mile of Clapham Junction.

Features

- Reception Room
- Double Bedroom
- Family Bathroom
- Superb Location
- Permit Parking Available
- Quiet Cul- De-Sac

**John Archer Way,
London, SW18**

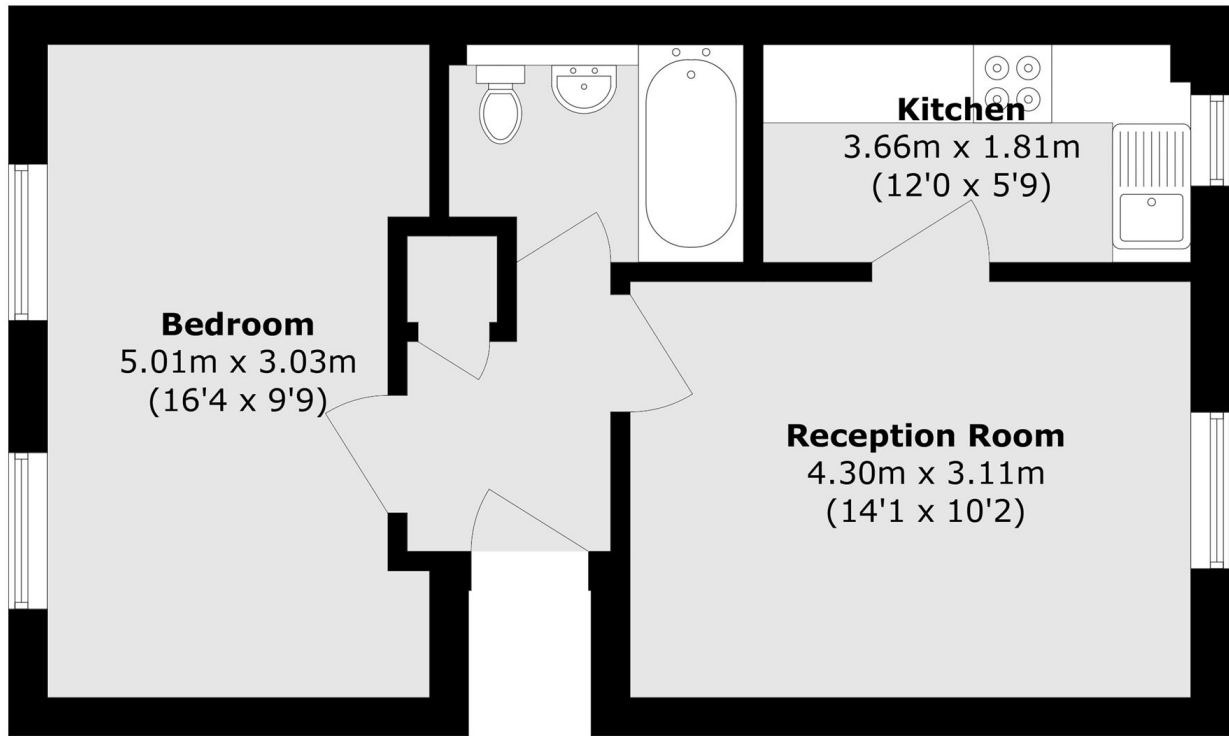

Total area (approx.): 42.2 sq. m (454.2 sq. ft)