



Borland Road, SE15

£385,000

Set within a modern and well maintained development this spacious one bedroom apartment offers generous living space a private balcony and the rare benefit of an allocated parking space making it an excellent first time purchase or downsize.

Alpha House is ideally positioned for access to Nunhead and Peckham Rye with excellent transport links into the City and West End alongside a growing selection of independent cafes restaurants and green spaces including Peckham Rye Park and Nunhead Cemetery.

Features

- One Bedroom Apartment
- Private Balcony
- Beautifully Presented
- Allocated Parking Space
- Share Of Freehold
- Great Location

Borland Road,
London, SE15

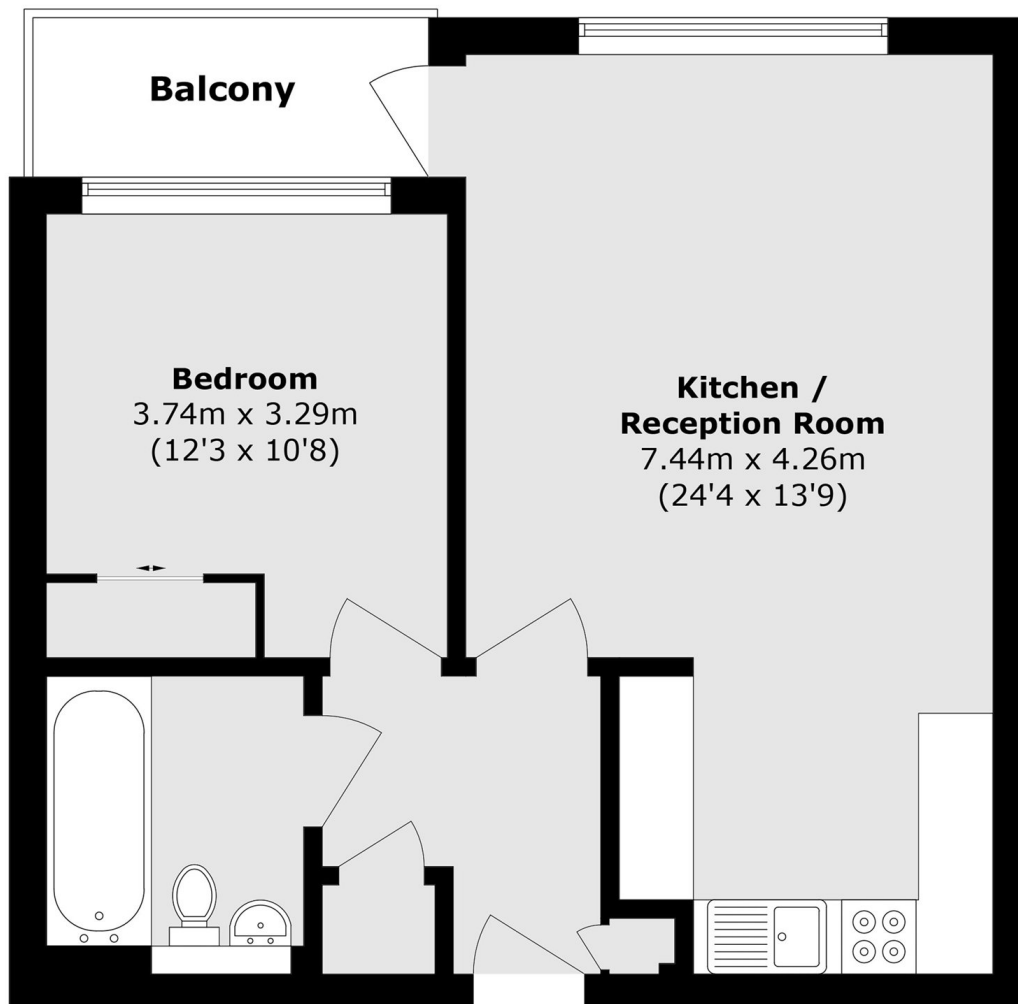

Total area (approx.): 52.5 sq. m (565.1 sq. ft)

Balcony area (approx.): 4.1 sq. m (44.1 sq. ft)

Dexters

Peckham Rye
2 Barry Parade
Barry Road
London
Sales
020 8742 4146

Energy Rating: C. We aim to make our particulars both accurate and reliable. However they are not guaranteed; nor do they form part of an offer or contract. If you require clarification on any points then please contact us, especially if you're traveling some distance to view. Please note that appliances and heating systems have not been tested and therefore no warranties can be given as to their good working order.

 **RICS** | Regulated
Estate Agent
and Letting Agent

[dexters.co.uk](https://www.dexters.co.uk)