



St. Asaph Road, SE4

£375,000

A two double bedroom top floor flat in an excellent location next to the well connected Nunhead Train Station. The flat is in turn key condition and boasts shared gardens as well as a communal car park.

Enviably located just a short walk from Nunhead and Queens Road Peckham stations along with the green spaces of Telegraph Hill, Nunhead Cemetery and Peckham Rye. The area's wide range of restaurants, bars and community events are on your doorstep.

Features

- Two Double Bedrooms
- Excellent Location
- Shared Garden
- Communal Car Park
- Private Asgard Bike Shed
- Long Lease

St. Asaph Road, London, SE4

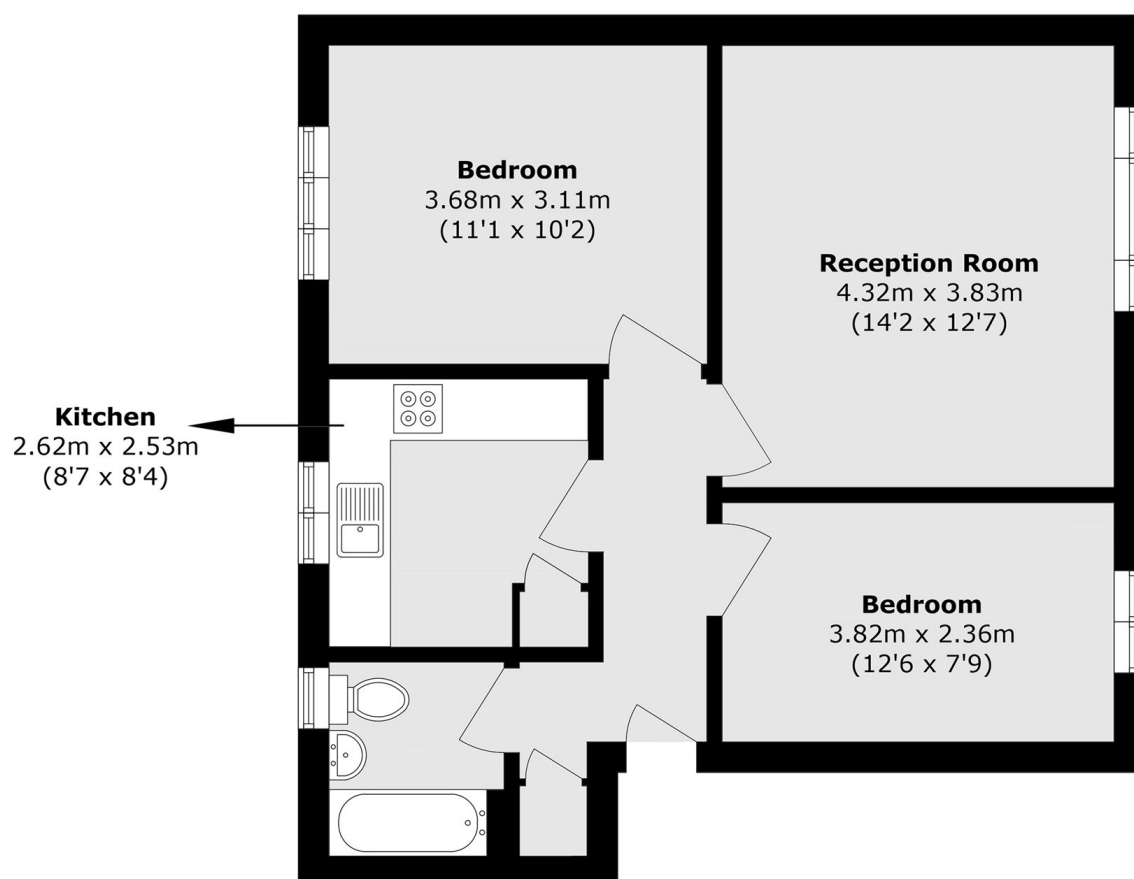

Total area (approx.): 55.2 sq. m (594.2 sq. ft)