



Chesterfield Gardens, W1J

£690 Per week

A recently refurbished one bedroom, one bathroom apartment located within a period red brick building with lift access.

Chesterfield House is ideally located on Chesterfield Gardens, close to the open spaces of both Hyde Park and Green Park.

Features

- Spacious Double Bedroom
- 24-Hour Porter
- Red Brick Building
- Recently Refurbished
- Excellent Location
- Lift Access

Chesterfield Gardens, London, W1J

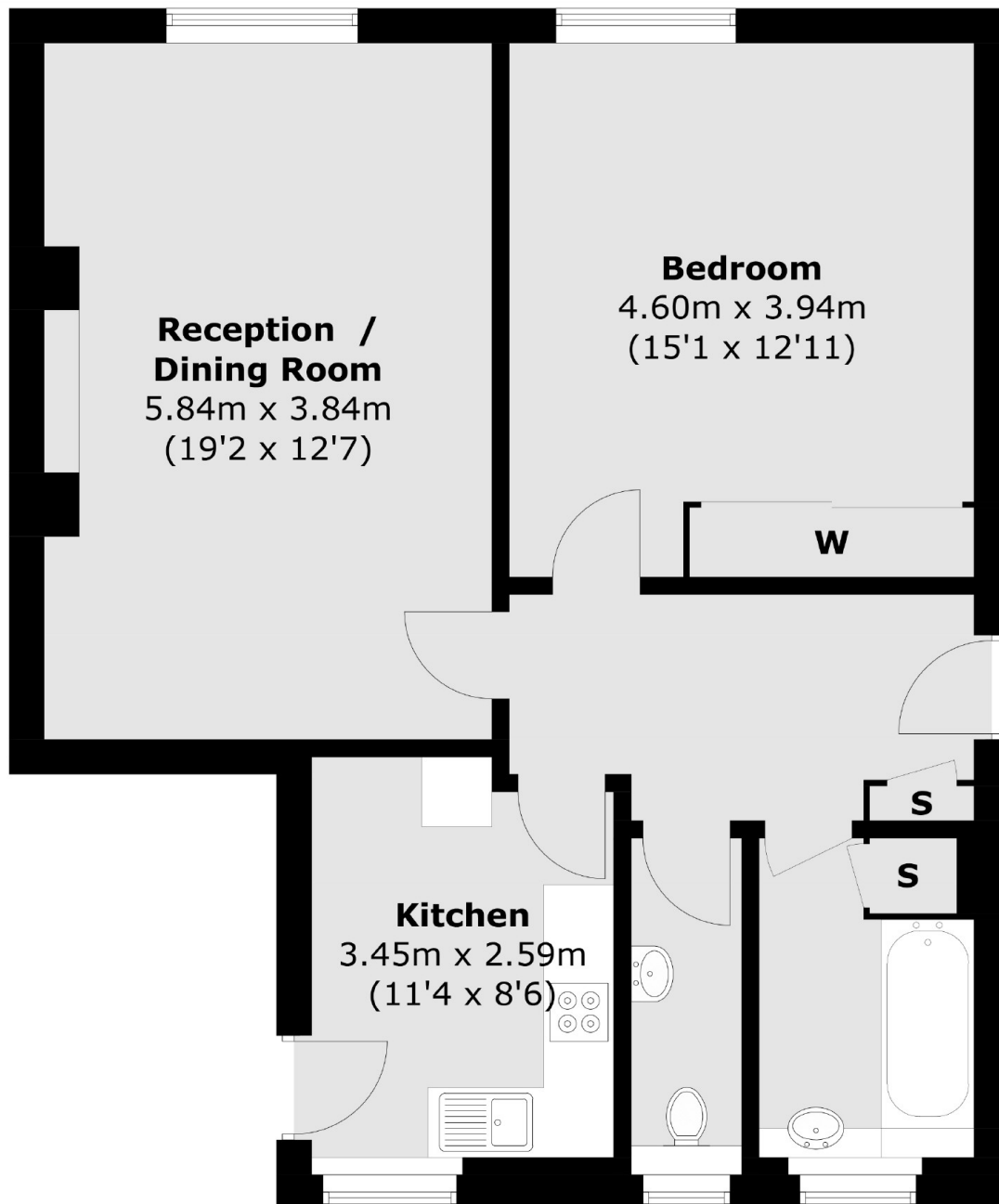

Fourth Floor

Total area (approx.): 67.6 sq. m (728.0 sq. ft)

Dexters

Mayfair
102 Mount Street
London
W1K 2TH
Lettings
020 7529 5588

Energy Rating: C. We aim to make our particulars both accurate and reliable. However they are not guaranteed; nor do they form part of an offer or contract. If you require clarification on any points then please contact us, especially if you're traveling some distance to view. Please note that appliances and heating systems have not been tested and therefore no warranties can be given as to their good working order.

 **RICS** | Regulated
Estate Agent
and Letting Agent

[dexters.co.uk](https://www.dexters.co.uk)