



Sellincourt Road, SW17

£675,000

An impressive and spacious split level ground floor maisonette composed of three generous double bedrooms, stunning kitchen and superb landscaped south facing garden.

Sellincourt Road is positioned enviably off the vibrant Tooting High Street, with its wide array of bars and restaurants. Tooting Broadway tube station and Tooting overground are only a short distance away.

Features

- Three Double Bedrooms
- Two Bathrooms
- Own Front Door
- Private South Facing Garden
- Meticulous Interior
- Desirable Location



Sellincourt Road, SW17

Entering through its own front door, the property opens onto a front reception room with a comfortable seating area. The ground floor is wonderfully balanced with a superb kitchen/dining space at the rear offering a fitted kitchen with integrated appliances and ample dining space. The kitchen opens onto a south facing garden that has been wonderfully landscaped and makes for an amazing outdoor space. The rest of the floor comprises a generous double bedroom and family bathroom.

On the lower ground floor level, there are two more spacious double bedrooms and a second family bathroom. One bedroom has access to an outdoor front courtyard.



Sellincourt Road, London, SW17

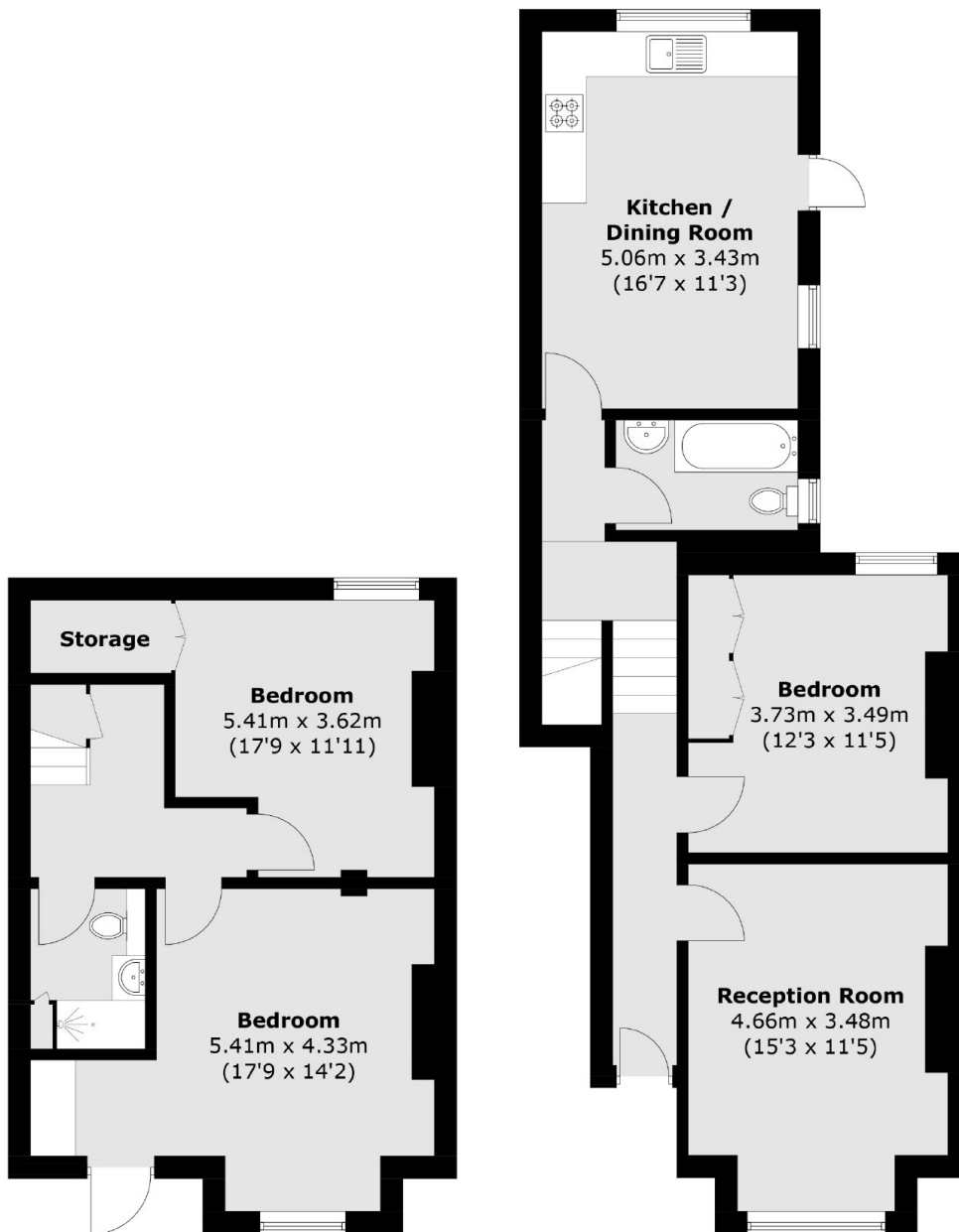

Lower Ground Floor

Ground Floor

Total area (approx.): 104.5 sq. m (1,124.8 sq. ft)

Dexters

Tooting
48 Tooting High Street
London
SW17 0RG
Sales
020 8545 8582

Energy Rating: C. We aim to make our particulars both accurate and reliable. However they are not guaranteed; nor do they form part of an offer or contract. If you require clarification on any points then please contact us, especially if you're traveling some distance to view. Please note that appliances and heating systems have not been tested and therefore no warranties can be given as to their good working order.

 **RICS** | Regulated
Estate Agent
and Letting Agent

[dexters.co.uk](https://www.dexters.co.uk)