



## Franciscan Road, SW17

### £400,000

A sublime example of a larger than average and newly converted one double bedroom apartment extending to just shy of 500 sqft of superb living space. The property retains a generous reception room with a fitted kitchen, a large double bedroom with fitted wardrobes and a stylish bathroom with a private balcony.

Franciscan Road is a highly desirable street sitting in the heart of Tooting with the many boutique shops, bars and restaurants of Tooting Broadway on one end and the vast green open spaces of Tooting Bec Common and Balham town centre on the other.

### Features

- Balcony
- Large Double Bedroom
- Chain Free
- Newly Converted
- Desirable Location
- Fitted Kitchen

# Franciscan Road, London, SW17

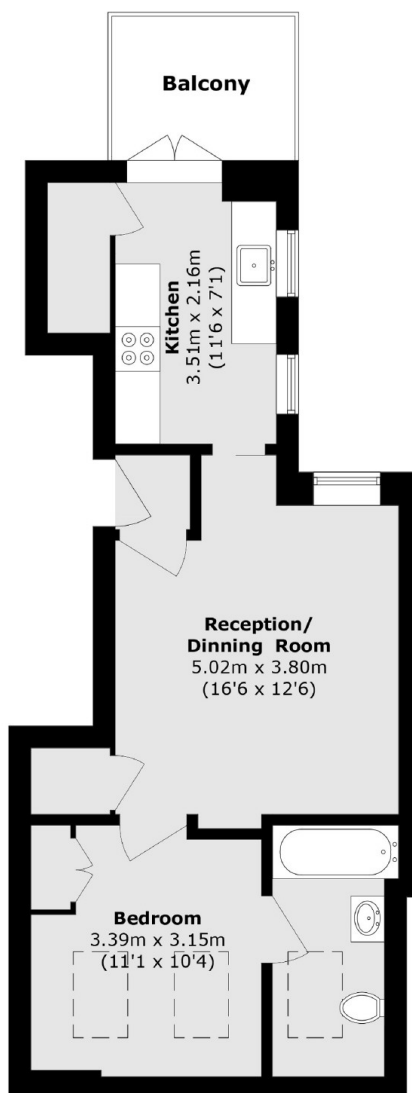

Total area (approx.): 44.9 sq. m (483.3 sq. ft)

Terrace area (approx.): 4.6 sq. m (49.5 sq. ft)

## Dexters

Tooting  
48 Tooting High Street  
London  
SW17 0RG  
Sales  
020 8545 8582

Energy Rating: B. We aim to make our particulars both accurate and reliable. However they are not guaranteed; nor do they form part of an offer or contract. If you require clarification on any points then please contact us, especially if you're traveling some distance to view. Please note that appliances and heating systems have not been tested and therefore no warranties can be given as to their good working order.

 **RICS** | Regulated  
Estate Agent  
and Letting Agent

[dexters.co.uk](https://www.dexters.co.uk)