



## Stanley Road, CR4

£2,400 Per calendar month

A well presented three double bedroom terrace house with a private garden, comprising three bedrooms, a further study/guest room and a separate reception room.

Stanley Road is conveniently located for the many shops, bars and restaurants of central Tooting with the excellent transport links of Tooting Railway and Tooting Broadway Underground stations within walking distance.

### Features

- Victorian House
- Three Bedrooms
- Large Reception
- Private Garden
- Study/Guest Room
- Great Transport Links

# Stanley Road, Mitcham, CR4

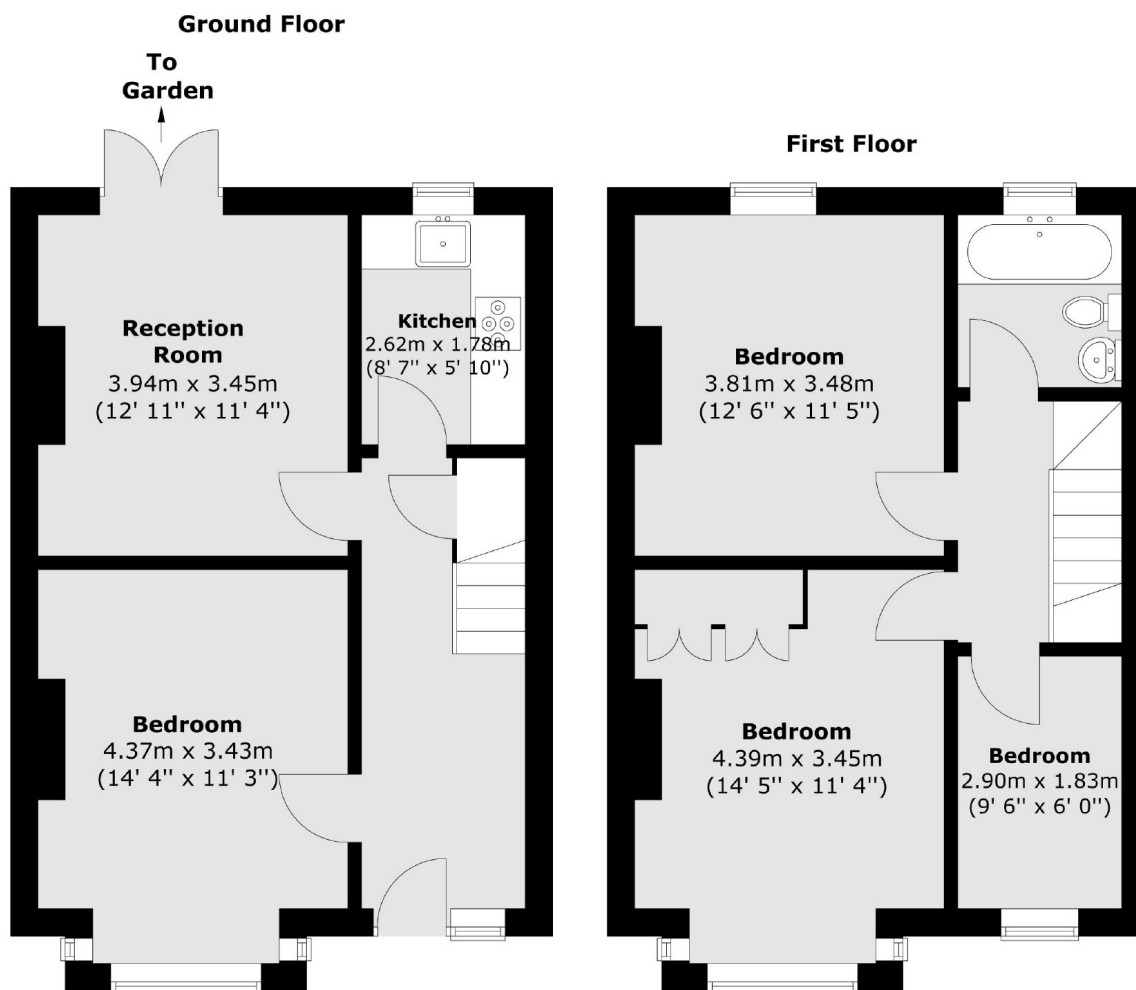

Total area (approx.) : 87.2 sq. m (939 sq. ft)