



Dennis Reeve Close, CR4

£585,000

A charming freehold home that has been lovingly maintained by the current owners and benefits a large plot comprising off-street parking and a large garden. Internally, the property benefits from a stylish kitchen, a large reception room, three generous double bedrooms and a three piece family bathroom.

Dennis Reeve Close represent a close knit community of homes moments away from Tooting and Mitcham looking onto Figges Marsh. The vast amenities of both Tooting and Mitcham town centres are on the doorstep with Tooting Railway Station only moments walk away.

Features

- Three Bedrooms
- Freehold Home
- Off-Street Parking
- Large Garden
- Stylish Interior
- Desirable Location

Dennis Reeve Close, Mitcham, CR4

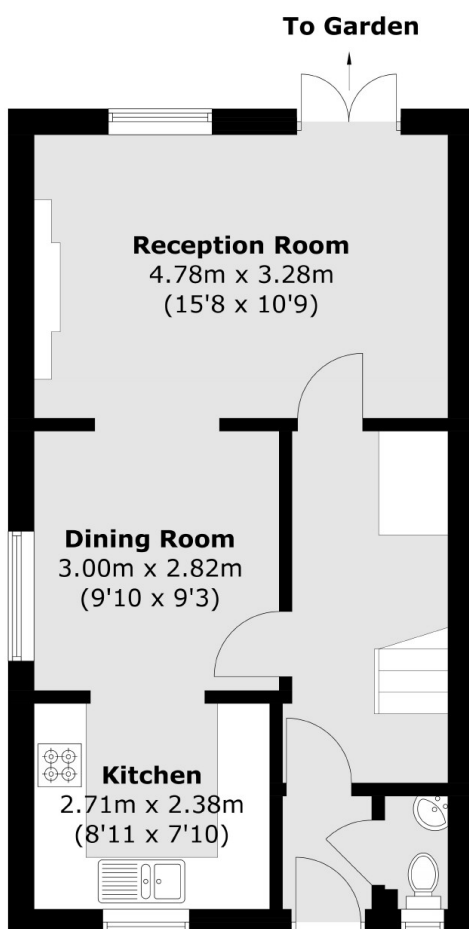

Ground Floor

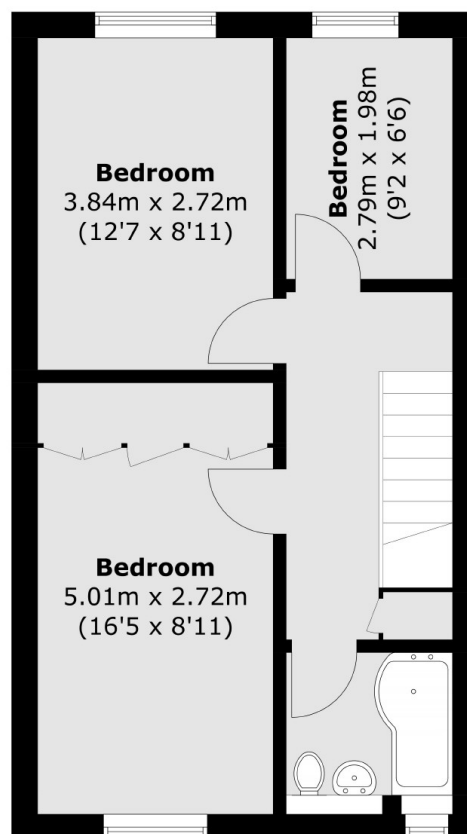

First Floor

Total area (approx.): 86.1 sq. m (926.7 sq. ft)