



Bickley Street, SW17

£475,000

A sizeable ground floor garden maisonette extending to 714 sqft in the heart of Tooting with huge scope for modernisation. Accommodation comprises a front reception room, two double bedrooms, a large kitchen and a private garden. The property is sold chain free and is a blank canvas for any incoming purchaser.

Bickley Street is conveniently located for the convenient and practical amenities of Tooting Broadway with it's many shops, bars and boutiques on the doorstep. The vast bus and underground transport links are also within walking distance.

Features

- Two Double Bedrooms
- Own Front Door
- Private Garden
- Share of Freehold
- Blank Canvas
- Front Reception Room

Bickley Street, London, SW17

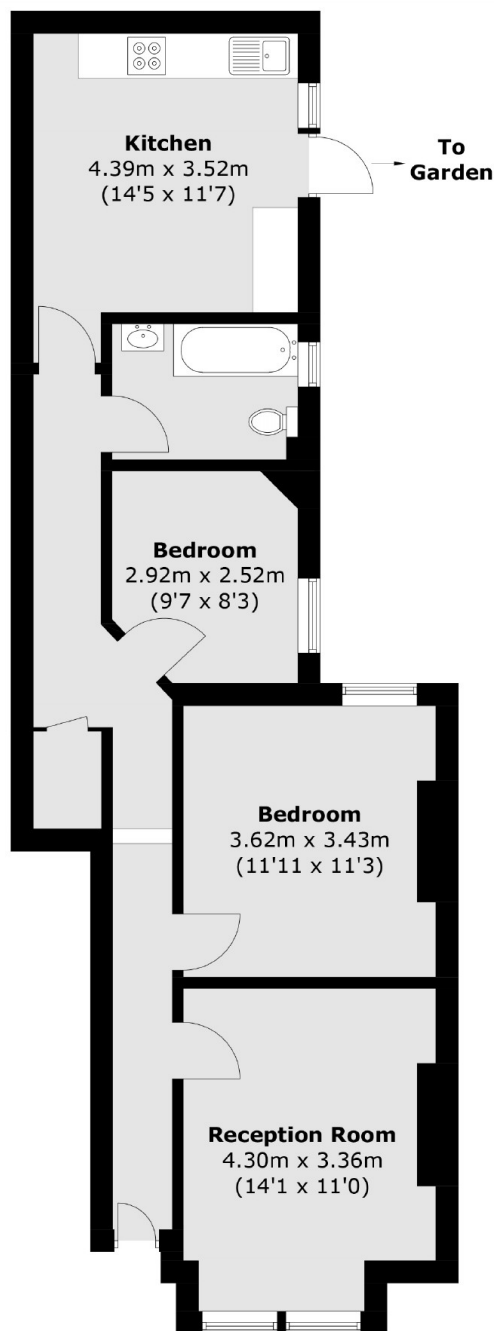

Total area (approx.): 66.4 sq. m (714.7 sq. ft)