



Ashvale Road, SW17

£375,000

A charming and well positioned one double bedroom ground floor apartment with a spacious interior benefitting from a large open-plan kitchen/reception room with a comfortable seating area, a large double bedroom, a three piece bathroom and a private westernly facing garden.

Ashvale Road is enviably positioned for the many shops, bars and restaurants of Tooting with Tooting Broadway underground station also on the doorstep. Frequent bus links and the vast eateries of Tooting Market are a stones throw away.

Features

- One Double Bedroom
- Private Garden
- Open-Plan Kitchen/Reception Room
- Desirable Location
- Long Lease
- Chain Free

Ashvale Road, London, SW17

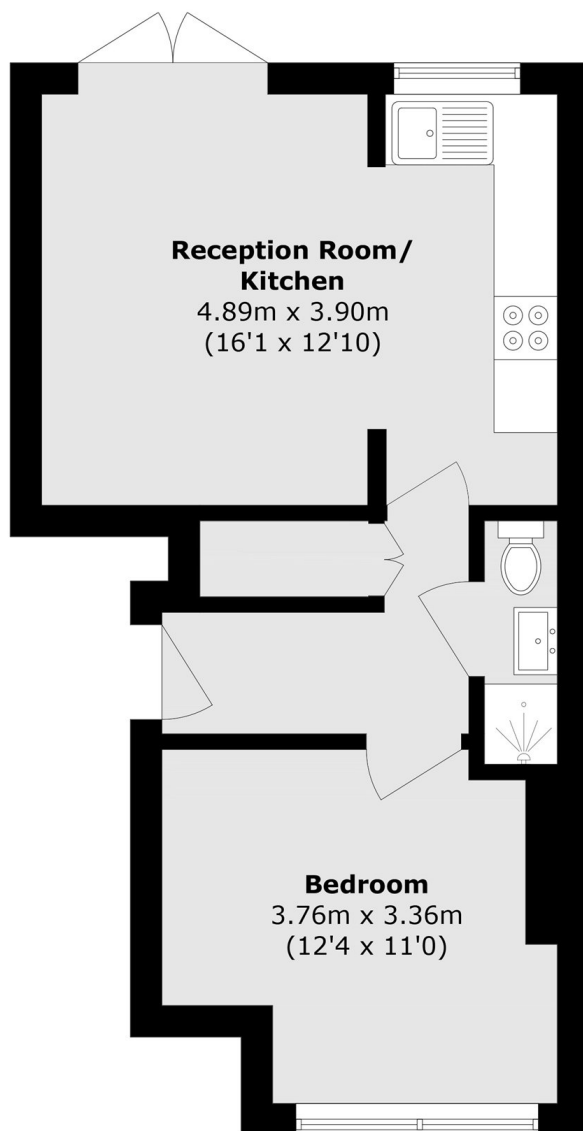

Total area (approx.): 39.0 sq. m (419.8 sq. ft)