

Ribblesdale Road, SW16

£2,100 Per calendar month

A recently refurbished two bedroom maisonette located in Furzedown. The property benefits from two bathrooms, a large open plan kitchen living area and a private garden, making it perfect for single professional or couple.

Ribblesdale Road located in the leafy Furzedown, is perfectly placed for a wide range of local amenities along Tooting High Road. Transport links can be found at Tooting Bec Underground (Northern Line) with the open spaces of Tooting Bec Common within easy reach.

Features

- Maisonette
- Two Bedrooms
- Two Bathrooms
- Private Garden
- Open Plan Kitchen Living Area
- Prime Location

Ribblesdale Road, London, SW16

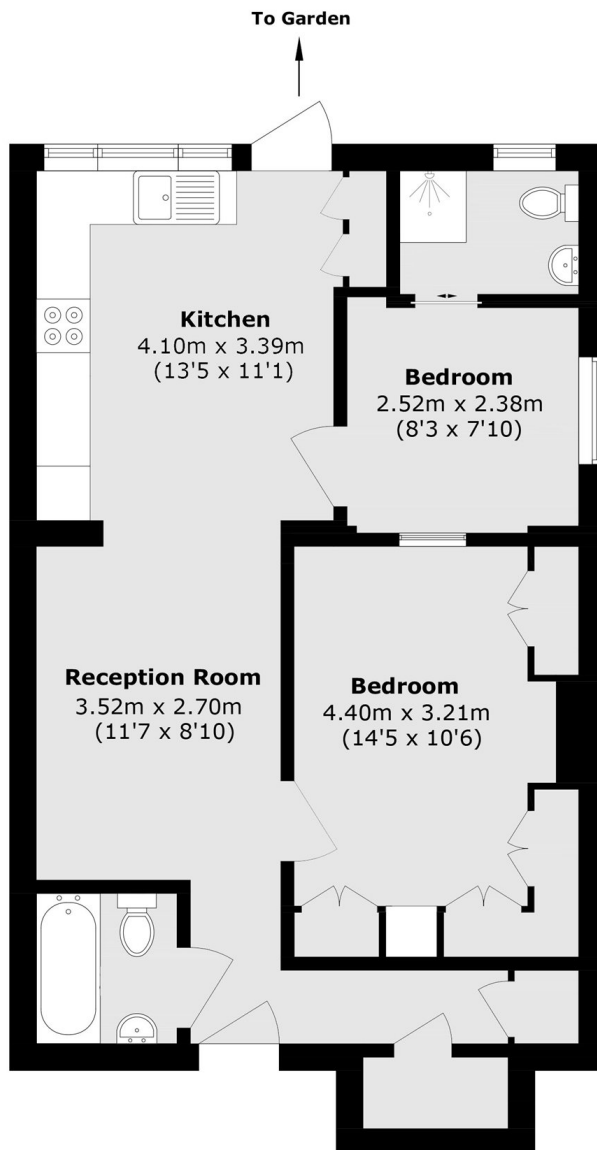

Total area (approx.): 60.6 sq. m (652.2 sq. ft)