

Frank Harris

— & Co. —



Bloomsbury, WC1X

£499,950

This one-double-bedroom home is set within a beautiful Grade II-listed Victorian building to the north of Gray's Inn. The kitchen features integrated appliances with direct access to the reception, and there is a modern bathroom along with ample storage throughout.



The flat occupies a prominent position on Theobalds Road, providing excellent access to both the Central and Piccadilly lines, as well as to a wide range of bars, restaurants, and shopping outlets.

- One Double Bedroom • Overlooking Gardens • Grand Victorian Building •
 - Long Lease • Excellent Location • Close to Transport •
-



Frank Harris & Co.

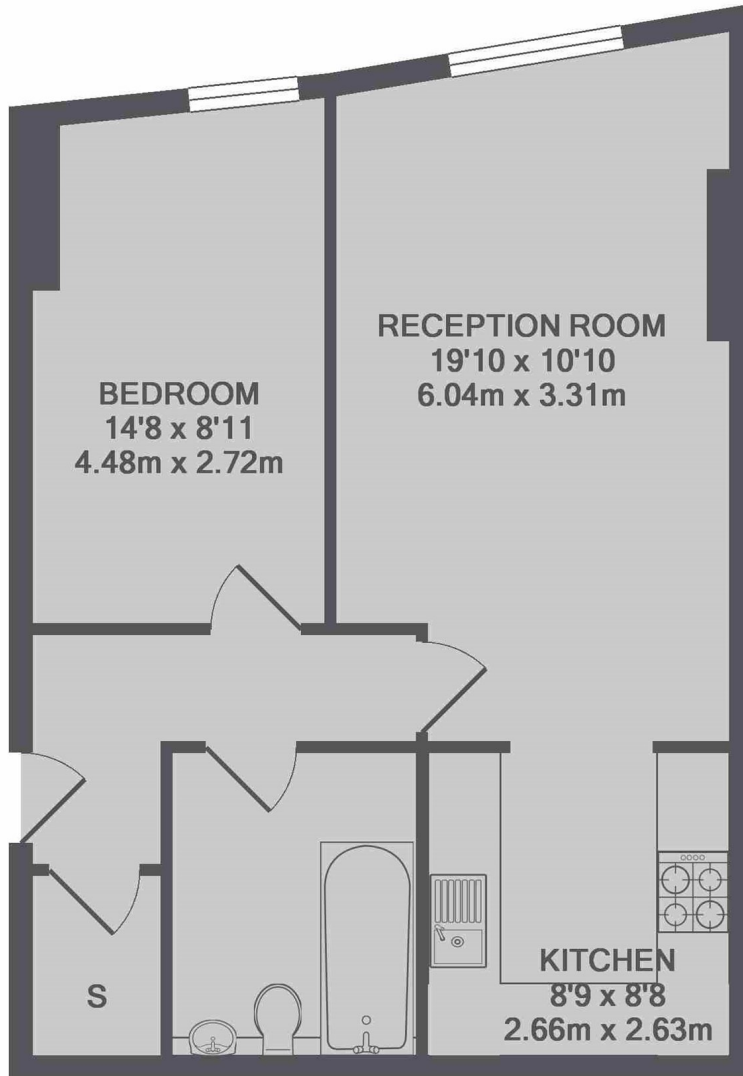

TOTAL APPROX. FLOOR AREA 532 SQ.FT. (49.4 SQ.M.)

Frank Harris & Co. Bloomsbury and Kings Cross
81 Marchmont Street,
London, WC1N 1AL
020 7405 4444
bloomsburysales@frankharris.co.uk

Energy Rating: C. We aim to make our particulars both accurate and reliable. However they are not guaranteed; nor do they form part of an offer or contract. If you require clarification on any points then please contact us, especially if you're traveling some distance to view. Please note that appliances and heating systems have not been tested and therefore no warranties can be given as to their good working order.

