



## Needleman Close, NW9

### £350,000

A delightful two double bedroom located on the second floor of this modern handsome block. This home comes with two bathrooms, large reception room, separate kitchen and is in great condition throughout.

Needleman Close is part of the popular Pulse development, situated moments from Colindale Underground Station and from the restaurants and cafés on Colindale Avenue.

### Features

- Two Double Bedrooms
- Second Floor
- Two Bathrooms
- Pulse Development
- Separate Kitchen
- Great Condition

# Needleman Close, London, NW9

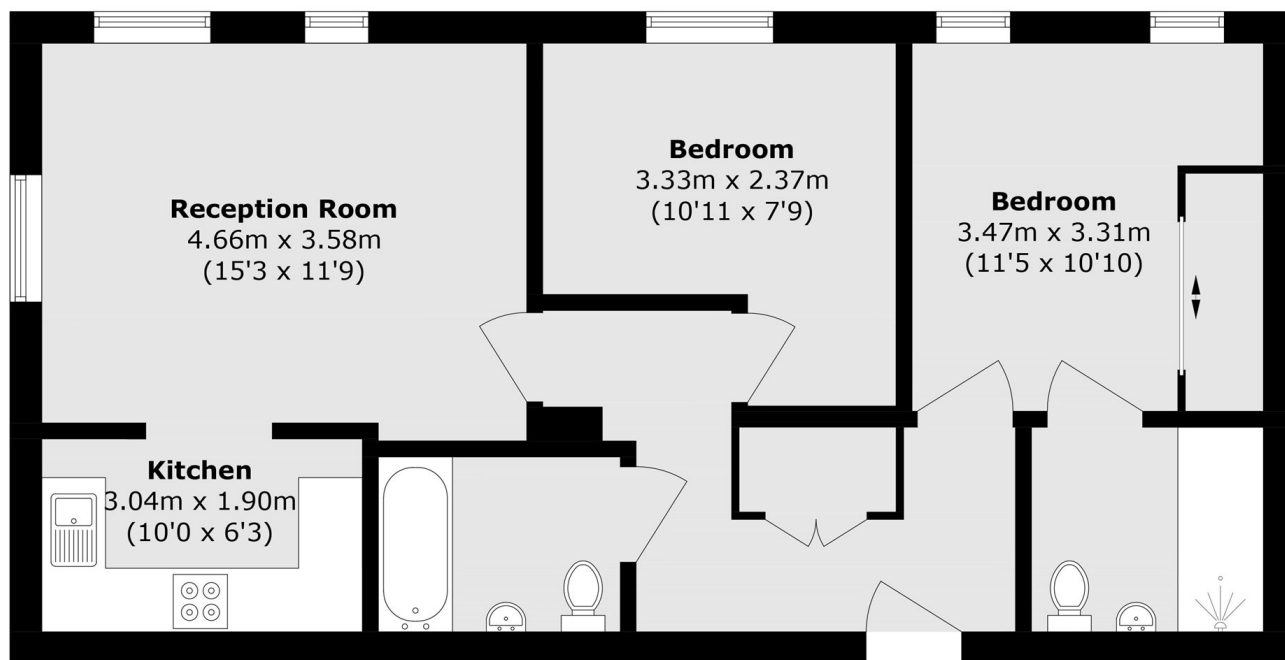

Total area (approx.): 63.8 sq. m (686.7 sq. ft)